



MERCURY 3D LED

REAR LAMPS

- Stop
- Position
- Turn indicator
- Reversing light
- Rear fog light













FRONT LAMPS

- D.R.L.
- Position
- Turn indicator

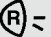

Legenda simboli

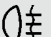
Icons legend

	Soccorso stradale <i>Rescue</i>	RH	Destro <i>Righ</i>
	Macchine movimento terra <i>Earth moving machines</i>	LH	Sinistro <i>Left</i>
	Furgoncino <i>Van</i>	STOP	Stop <i>Brake</i>
	Autogru <i>Cranes</i>		Posizione <i>Position</i>
	Spazzatrici stradali <i>Road sweepers</i>		Direzione <i>Turn indicator</i>
	Trattori <i>Tractors</i>		Retromarcia <i>Reversing light</i>
	Macchine da raccolta <i>Harvest machineries</i>		Retronebbia <i>Rear fog light</i>
	Autobus <i>Bus</i>	D.R.L.	Daytime Running Lamp
	Automobili <i>Cars</i>		

MERCURY 3D LED

FANALI ANTERIORI E POSTERIORI / FRONT AND REAR LAMPS









- NUOVA GAMMA DI FANALI ANTERIORI E POSTERIORI
- DESIGN 3D
- TECNOLOGIA A LED
- MULTIFUNZIONE
- ALIMENTAZIONE: 12V o 24V
- OMOLOGAZIONE: ECE o SAE

- NEW RANGE OF FRONT AND REAR LAMPS
- 3D DESIGN
- LED TECHNOLOGY
- MULTIFUNCTIONAL
- POWER SUPPLY: 12V or 24V
- HOMOLOGATION: ECE or SAE

SPECIFICHE TECNICHE

Technical specifications

	Alimentazione <i>Power supply</i>	12V or 24V
	Tipo di illuminazione <i>Type of lighting</i>	LEDs
	Grado di protezione <i>Sealing degree</i>	IP66 + IP9K
	Temperatura di funzionamento <i>Operating temperature</i>	- 30° C ÷ + 50° C
	Temperatura di stoccaggio <i>Storage temperature</i>	- 40° C ÷ + 85° C
	Omologazione <i>Homologation</i>	ECE or SAE
EMC	Compatibilità elettromagnetica <i>Electromagnetic compatibility</i>	ECE R10
ISO	International Standards Organization	Turn indicator compliant to ISO 13207-1

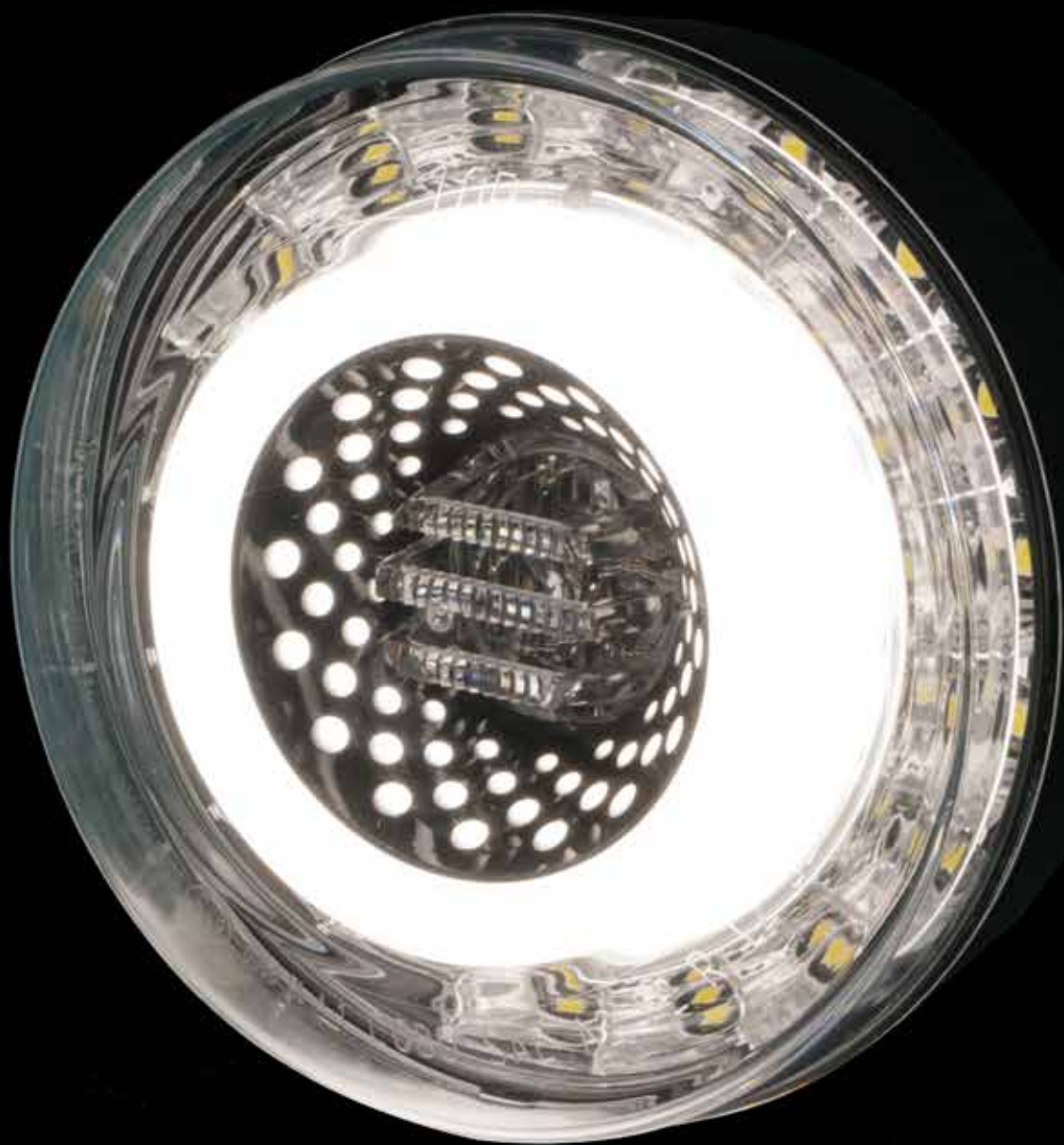

MERCURY 3D LED

FANALI ANTERIORI / FRONT LAMPS

12V
or 24V



D.R.L.
Daytime Running Lamp



Posizione
Position



Direzione
Turn indicator



3D
Effect

MERCURY 3D LED

FANALI ANTERIORI / FRONT LAMPS

12V
or 24V

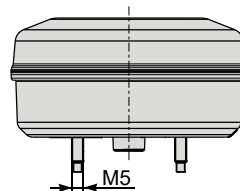
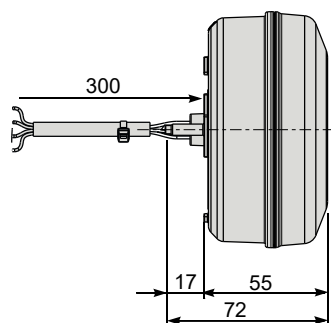
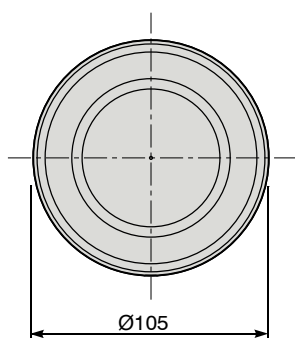

Foratura di applicazione
Fixing hole

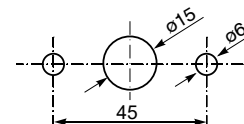

OPTIONAL KIT

Connettore controparte / Mating connector
SUPERSEAL 4 pins

P/N **1028520** (27-0906-0000)

(Includes: connector, rubber taps, female terminals)

MERCURY 3D LED

FANALI ANTERIORI / FRONT LAMPS

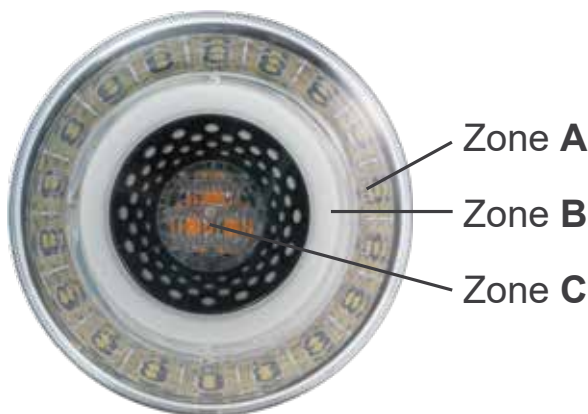
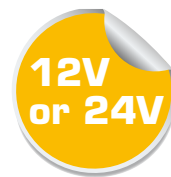

P/N	Pkg Q.ty	Alimentazione Power Supply	Lato montaggio Mounting Side	Funzioni Functions			Colore Lente Lens Color	Omologazione Homologation	Connessione Connection
				Zone A	Zone B	Zone C			
1094767 1094768 03-1008-0000	1 40	12V	LH - RH	 D.R.L.	 ≡D≡	 ⇄⇄	○○	ECE	Connector SUPERSEAL 4 pins Cable 300 mm
1099492 1099491 03-1022-0000	1 40	24V	LH - RH	 D.R.L.	 ≡D≡	 ⇄⇄	○○	ECE	Connector SUPERSEAL 4 pins Cable 300 mm

--	--	--	--	--	--	--	--	--	--

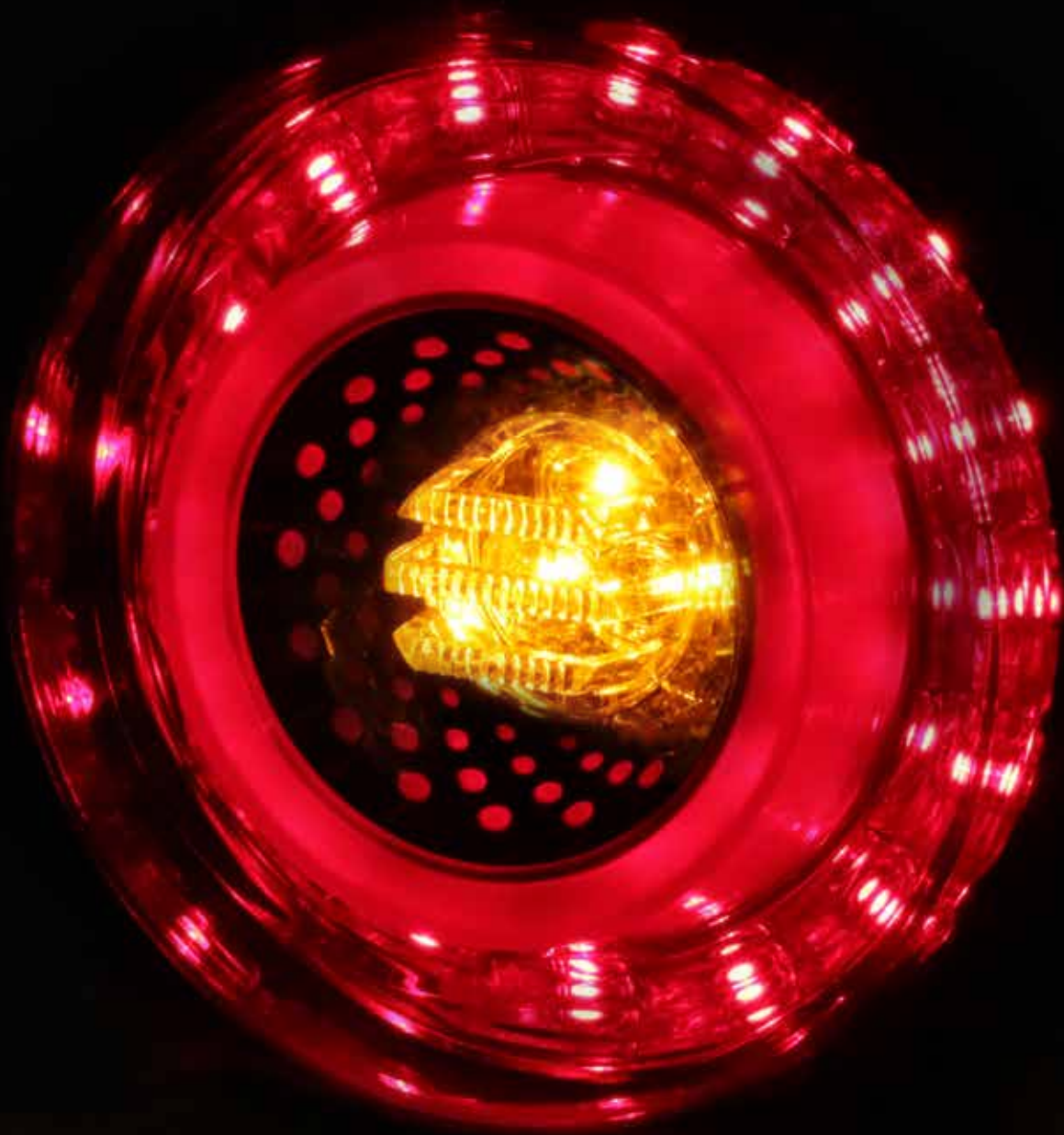

MERCURY 3D LED

FANALI POSTERIORI / REAR LAMPS

12V
or 24V



Stop / Posizione
Brake / Position



Posizione / Direzione
Position / Turn indicator



Direzione
Turn indicator



3D
Effect

MERCURY 3D LED

FANALI POSTERIORI / REAR LAMPS

12V
or 24V

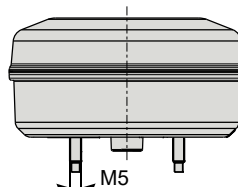
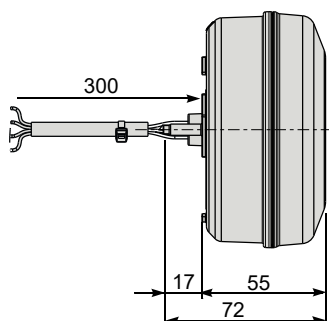
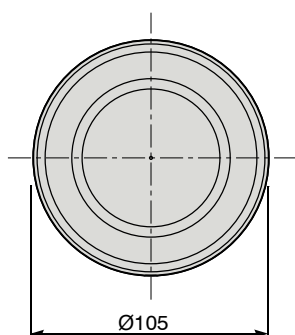

Foratura di applicazione
Fixing hole

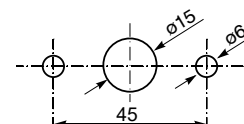

OPTIONAL KIT

Connettore controparte / Mating connector
SUPERSEAL 4 pins

P/N **1028520** (27-0906-0000)
(Includes: connector, rubber taps, female terminals)



OPTIONAL KIT

Connettore controparte / Mating connector
SUPERSEAL 3 pins

P/N **1028518** (27-0905-0000)
(Includes: connector, rubber taps, female terminals)

MERCURY 3D LED

FANALI POSTERIORI / REAR LAMPS

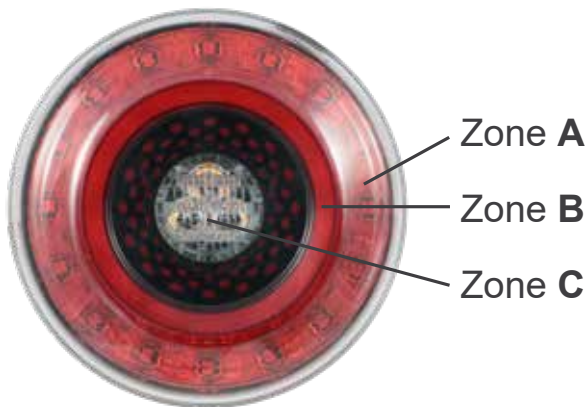
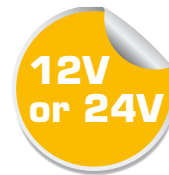

P/N	Pkg Q.ty	Alimentazione Power Supply	Lato montaggio Mounting Side	Funzioni Functions			Colore Lente Lens Color	Omologazione Homologation	Connessione Connection
				Zone A	Zone B	Zone C			
1094689 1094692 02-1911-0000	1 40	12V	LH - RH				● ○	ECE	Connector SUPERSEAL 4 pins Cable 300 mm
				STOP					
1099479 1099480 02-1962-0000	1 40	24V	LH - RH				● ○	ECE	Connector SUPERSEAL 4 pins Cable 300 mm
				STOP					
1094708 1094709 02-1912-0000	1 40	12V	LH - RH	----			● ○	ECE	Connector SUPERSEAL 3 pins Cable 300 mm
1094740 1094741 02-1915-0000	1 40	12V	LH - RH	----			● ●	ECE	Connector SUPERSEAL 3 pins Cable 300 mm
1094736 1094737 02-1914-0000	1 40	12V	LH - RH				● ●	SAE	Connector SUPERSEAL 4 pins Cable 300 mm
				STOP					

GERMANY



COBO DEUTSCHLAND GmbH
Zum Schürmannsgraben, 12E
D-47441 - Moers
Germany
Phone: +49 (0) 2841 88238 0
Fax: +49 (0) 2841 88238 23
E-mail: info@cobogroup.net
Web Site: www.cobo-deutschland.com

FRANCE



COBO FRANCE Sarl
Allée de l'Europe, 2 - Zone Coriolis
71210 - Ecuisses
France
Phone: +33 (0) 3 857 30560
Fax: +33 (0) 3 857 85606
E-mail: info@cobogroup.net
Web Site: www.cobofrance.com

NORTH AMERICA



COBO USA Ltd
West Division Street, 304
52655 - West Burlington
Iowa - Usa
Phone: +1 319 754 5585
Fax: +1 319 754 8724
E-mail: info@cobogroup.net
Web Site: www.cobointernational.com

LATIN AMERICA



COBO COMPONENTES AGR. E IND. Ltda
Rua Dona Francisca, 8300 - Bloco 2-M
89219-600 Zona Industrial - Joinville
Santa Catarina - Brasil
Phone: +55 47 3305 0095
E-mail: info@cobogroup.net
Web Site: www.cobogroup.net

OCEANIA



COBO OCEANIA Ltd
Maiella Street, 4/12
4207 Stapylton - Brisbane
Queensland - Australia
Phone: +61 (0) 7 3807 4866
Fax: +61 (0) 7 3807 6780
E-mail: info@cobogroup.net
Web Site: www.cobo.com.au

SOUTH-EAST ASIA



COBO ASIA Ltd
Heung Yip Road, 2 - One Island South
622 6/F Unit - Wong Chuk Hang
Hong Kong
Phone: +852 3590 3588
Fax: +852 3590 3566
E-mail: info@cobogroup.net
Web Site: www.cobogroup.net

CHINA



COBO GUANGZHOU Ltd
Qiaotou Street, 226 - Beishan - Haizhu
51000 - Guangzhou
People's Republic of China
Phone: +86 20 8922 5611
Fax +86 20 8922 5635
E-mail: info@cobogroup.net
Web Site: www.cobochina.cn

INDIA



COBO INDIA Branch Office
Mathura Road, 13/6 - 4th floor, 403
121003 NH-2 - Faridabad
Haryana - India
Phone: +91 129 4871206
Email: info@cobogroup.net
Web Site: www.cobogroup.net



C.O.B.O. SpA

Via Tito Speri, 10
25024 Leno (Brescia) ITALY
Phone +39 030 90451
Fax +39 030 9045330



info@cobogroup.net | www.cobogroup.net

Le informazioni contenute nella presente informativa hanno scopo puramente indicativo.
L'Azienda si riserva senza preavviso il diritto di apportare qualsiasi modifica tecnica del prodotto.
The information published in this catalogue is purely indicative. The Company reserves the right to introduce all technological changes of the present product at any time and without prior notice.