





NANHUA

The logo for Nanhua Electronics Co., Ltd. features the company name in a bold, sans-serif font. Each letter is filled with a collage of industrial and manufacturing-related images, such as factory floors, machinery, and workers. The logo is centered between two solid red rectangular blocks.





- 

Passed the vibration test can apply to most vibration environment
- 

Totally protected against dust and low pressure jets of water from all directions - limited ingress.
- 

Totally protected against dust and temporary flooding of water-limited ingress permitted.
- 

Totally protected against dust and long periods of immersion under pressure.
- 

CE CERTIFICATE
- 

South African Bureau of Standards Certificate
- 

International Civil Aviation Organization
- 

The United Kingdom Accreditation Service Certificate
- 

Patent products
- 

Passed the test by National Institute of Metrology P. R. China
- 

SOUTH AFRICAN CIVIL

About Nanhua

Every year accidents occur all over the world because of safety troubles. Injury and wound death happen in industry working environment is far more than that in after-working environment.

Since 1990, we have kept focusing on people working under hazardous environments, from harbor to mining fields, metallurgical plant, tall building, high-way, and off-shore site etc. Our engineers go to all the above work sites to develop more reliable industry warning & communication products.

Our Philosophy

Nanhua believes in the plain philosophy. Focus on providing the best products and service to clients is the reason for Nanhua's existence. We believe that enterprise and employee's value can only be realized by long-term hardworking.

Nanhua pursues wide horizon we believe imaginative work can change the world. We wish that Nanhua could be an internationally competitive firm. Through lasting hard working we expect a prosperous future.

Nanhua dedicates to creating an equal, free and open working environment. We respect each employee's personality and hope all of them can work in Nanhua happily. Meanwhile, we would like to undertake responsibility and to share happiness together with clients, cooperators and colleagues.

Tone selection instruction

- | | |
|--|------------------------------------|
| A Tone – Di Da Di Da..., Intermittent | Y Tone – Wu..., Consistent |
| B Tone – Wu Wa Wu Wa, Police Siren | L Tone – Ang..., Consistent |
| D Tone – Du..Du..Du, Intermittent | F Tone – Dang.. Dang..Dang, |
| E Tone – Firefight siren, Consistent | |
| Horn – Ship horn tone, Consistent | |
| Bell – Classroom bell tone, Consistent | |

Voltage instruction

Default voltage: AC220V / DC24V

Special voltage: AC380V / AC110V / AC48V / AC42V / AC36V / AC24V / DC220V / DC12V / etc.

For all products, please specify on purchasing order tone and voltage requirements .

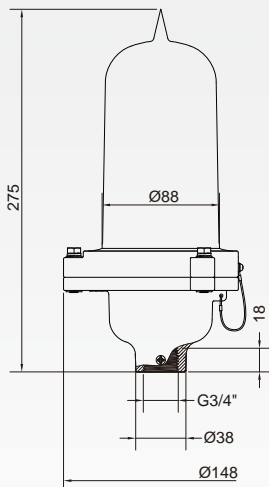

ABC-7L Aviation Obstruction Light

Application

ABC-7L Single Aviation Obstruction Light for marking towers (Telecom, GSM), Cranes, Hoists, Smokestacks, Buildings, Wind generator and any other potentially hazardous obstructions to air traffic.

Main Functions & Features

- Base is made of die casting aluminum alloy, with light weight and corrosion resistance.
- ABC-7A (LED) bulb uses super brightness LED, and its life time more than 100,000hrs.
- PC cover is used for ABC-7A (LED) bulb providing good intensity, thermal stability and good finishing surface.
- The lamp housing and upper lamp holder are sealed with structural glue, to ensure the good watertight of the product.
- A bird spike is provided on the top to avoid the perch of the bird.
- Built-in photocell can switch ON / OFF the light at dawn and night automatically (optional).

Specification

Description	Parameter
International standard	ICAO (Aerodromes Annex 14) Low intensity ; FAA – L810
Light source	LED
Light color	Red, Amber, Green, Blue, White (Optional)
Vertical degree	≥10°
Horizontal degree	360°
Working mode	Steady burning or flash (optional)
Operating voltage	AC110V~AC240V / DC12V / DC24V / DC40V~DC60V (other voltage can be customized)
Power consumption	5W
Intensity	>10cd
Visible distance	>3.5KM (AT=0.85)
LED lifetime	≥100,000hrs
Ambient temperature	-30°C ~ +70°C
Humidity	10% ~ 95% (no condensing)
IP protection	IP65
Material	Base : aluminum alloy Housing : PC
Weight	1.25kg



LS708 Aviation Obstruction Light



Application

Obstruction light for a wide variety of cranes used in Harbors, Metallurgies, Towers (Telecom, GSM), Smokestacks, Buildings and any other potentially hazardous obstructions to air traffic with a steady burning red safety light.

Main Functions & Features

- Based on LED technology, low power consumption, and high efficiency.
- Aluminum die casting enclosure with powder-coat paint finishes providing corrosion resistance and durability.
- Extremely Reliable – Major Maintenance Cost Saving.
- G3 / 4" pipe is available, ease of mount.
- EMC Compliance, No RF Radiation.
- Self-contained compartment, with stainless steel wire which is used to secure the unit against falling in operation, and ease of mount.
- Lamp housing – Polycarbonate, with good anti – impact strength, thermal stability, high transmittance.
- Built – in photocell can switch ON / OFF the light at dawn and dusk (optional).
- Steady burning or flashing type (optional).



Specification

Description	Parameter
International standard	Compliant to the ICAO (Aerodromes Annex 14) and FAA L – 810
Light source	LED
Light color	Aviation red
Vertical degree	≥10°
Horizontal degree	360°
Flashing rate	30 times / min
Power supply	AC110V-AC240V / DC40V-DC60V (optional)
Power consumption	8W
LED lifetime	≥100,000hrs
On / off level	50lux
Working mode	Steady burning or flashing mode
Intensity	≥32.5cd
Ambient temperature	-30°C ~ +70°C
Humidity	10% ~ 95% (no condensing)
IP protection	IP65
Material	Base:die casting aluminum; housing:PC
Weight	1.25kg

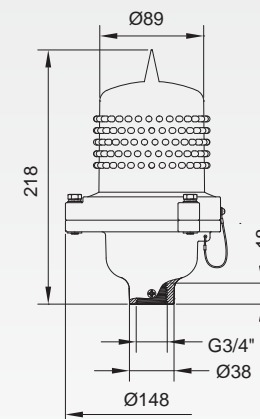



LS710/LS710L Aviation Obstruction Light

Application

Obstruction light for a wide variety of cranes used in Harbors, Metallurgies, Towers (Telecom, GSM), Smokestacks, Buildings and any other potentially hazardous obstructions to air traffic with a steady burning red safety light.



Main Functions & Features

- Use Fresnel lens, high utilization of light, valid keeping light beam in the scope as required.
- Based on LED technology, low power consumption, and high efficiency.
- Die casting aluminum enclosure with powder-coat paint finishes, providing corrosion resistance and durability.
- Extremely Reliable – Major Maintenance Cost Saving.
- G3/4" pipe is available, ease of mount.
- EMC Compliance, No RF Radiation.
- Self – contained compartment, with stainless steel wire which is used to secure the unit against falling in operation, and ease of mount.
- Lamp housing – Polycarbonate, with good anti – impact strength, thermal stability, high transmittance.
- Built – in photocell can switch ON / OFF the light at dawn and dusk (optional).
- Steady burning or flashing type (optional).

Specification

Description	Parameter
International standard	Compliant to the ICAO (Aerodromes Annex 14) and FAA – L810
Light source	LED
Light color	Aviation red (other color can be customized)
Vertical degree	≥10°
Horizontal degree	360°
Working mode	Steady burning or flash (optional)
Operating voltage	AC110V~AC240V
Power consumption	6W
Intensity	≥32.5cd
LED lifetime	≥100,000hrs
On / off level	500lux
Ambient temperature	-30°C ~ +70°C
Humidity	10% ~ 95% (no condensing)
IP protection	IP65
Material	Base: die casting aluminum; Housing: PC
Weight	1.0kg

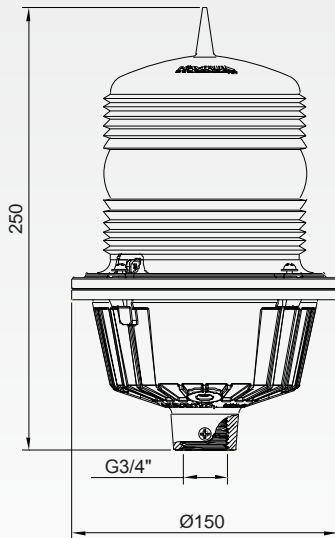

ABC-7M Medium Intensity Aviation Obstruction Light



Application

ABC – 7M Medium intensity obstruction light for marking Towers (Telecom, GSM), Smokestacks, Buildings and any other potentially hazardous obstructions to air traffic with a steady burning red safety light.

Main Functions & Features

- Modular design and meets optics standard, compact size and high efficiency.
- Based on LED technology.
- Extremely Reliable – Major Maintenance Cost Saving.
- Resistant to Vibration and Corrosion.
- Self-contained wiring compartment – eliminates additional boxes.
- Base material – Die casting aluminum.
- Housing – Polycarbonate, good anti-impact strength, thermal stability, high transmittance.
- Reflector – ABS.
- Combustibility rating: UL94V0.
- Typical LED lifetime: $\geq 100,000$ hrs.



Specification

Description	Parameter
International standard	ICAO (Annex) Type B; FAA – L864
Light source	LED
Light color	red
Vertical degree	3°
Horizontal degree	360°
Flashing rate	40 times / min
Operating voltage	AC110V~AC240V / DC48V / DC24V
Power consumption	60W (steady) 15W (flashing)
Flash duration	150±20ms
LED lifetime	$\geq 100,000$ hrs
Intensity	2000±25% cd
On / off level	50lux
Ambient temperature	-30°C ~ +70°C
Humidity	10% ~ 95% (no condensing)
IP protection	IP65
Material	Base: aluminum Housing: PC
Weight	4.0kg

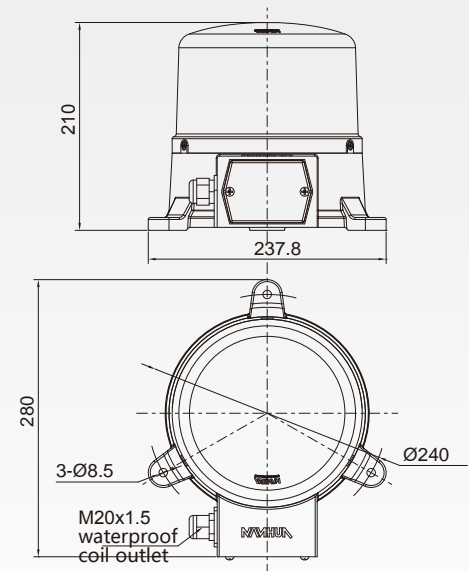



LM101 Medium Intensity Aviation Obstruction Light

Application

LM101 Medium intensity obstruction light for marking Towers (Telecom, GSM), Smokestacks (heat – engine plant, coking plant, chemical plant etc), Buildings, Port devise, Construction machinery, wind power generator etc for air traffic warning.

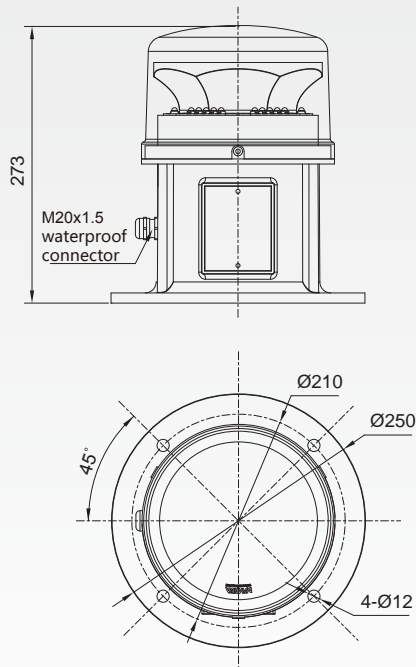

Main Functions & Features

- Based on LED technology, meets optics standard.
- Built – in circuit protect LED, extremely reliable and cost saving.
- Shockproof and corrosion resistant.
- Reflector : ABS material and vacuum plating.
- Combustibility rating : UL94 – V0.

Specification

Description	Parameter
International standard	ICAO (Annex 14) medium intensity aviation obstruction light standard and FAA – L864
Light source	LED
Light color	Red
Vertical degree	3°Min
Horizontal degree	360°
Flashing frequency	Adjustable (20-60times / min, 30times / min in default)
Operating voltage	DC48V / AC200-240V (other voltage can be customized)
Flashing duration	150±20ms
Power consumption	30W (Steady) / 6W (30FPM)
Light source power	30W
Intensity	2000±25% cd
LED lifetime	≥80,000hrs
On / off level	50lux
Ambient temperature	-40°C ~ +70°C
Humidity	10% ~ 95% (no coagulation)
IP protection	IP65
Material	Base: aluminum alloy; Housing: PC; Reflector: ABS, vacuum plating
Weight	4.5kg

LM201 Medium Intensity Aviation Obstruction Light



Application

LM201 Medium intensity obstruction light for marking Towers (Telecom, GSM), Smokestacks (heat – engine plant, coking plant, chemical plant etc), Buildings, Port devise, Construction machinery, wind power generator etc for air traffic warning.

Main Functions & Features

- Based on LED technology and meets optics standard.
- Built – in circuit protect LED, extremely reliable and cost saving.
- PC lampshade with high shock strength, heat resistance and good gloss.
- Shockproof and corrosion resistant.
- Reflector: ABS material and vacuum plating.
- Combustibility rating: UL94 – V0.
- Flash synchronous with GPS based on UTC, no need external synchronous wires (optional).

Specification

Description	Parameter
International standard	ICAO (Annex 14) medium intensity aviation obstruction light standard
Light source	LED
Light color	white
Vertical degree	3°
Horizontal degree	360°
Flashing frequency	30FPM (20 / 60FPM adjustable)
Operating voltage	200 ~ 240VAC
Power consumption	60W (Steady)
Lamp power	60W
Flashing duration	150±20ms
LED lifetime	≥100,000hrs
Intensity	2000cd±25% cd
Ambient temperature	-40°C ~ +70°C
Humidity	10% ~ 95% (no coagulation)
IP protection	IP65
Material	Body: aluminum alloy; housing: PC
Weight	5.5kg

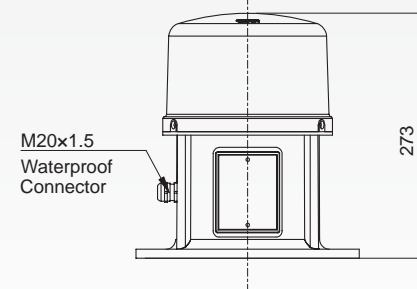
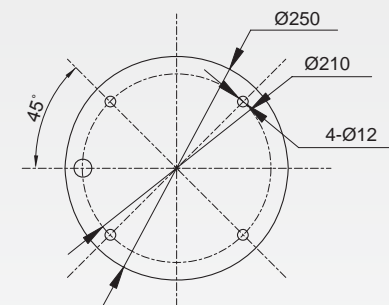



LM100 Medium Intensity Aviation Obstruction Light

Application

LM100 Medium intensity obstruction light for making Towers (Telecom, GSM), Smokestacks (heat – engine plant, coking plant chemical plant etc), Buildings, Port devise, Construction machinery, wind power generator etc for air traffic warning.

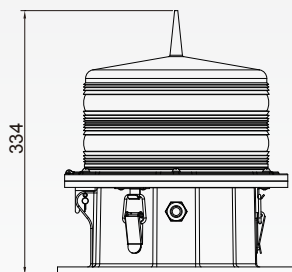
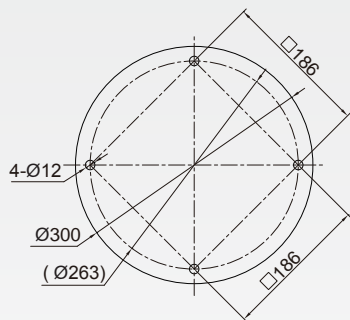

Main Functions & Features

- Optics design based on fresnel lens principle.
- Based on LED technology, with external long life, low power consumption and high efficiency.
- PC lamp housing with the sound impact resistance, thermal stability and luster effect.
- Die casting aluminum base, shockproof and corrosion resistant.
- No RF – radiations, EMC Compliant. And constant LED drive to prolong led life.
- Sealed material: waterproof sealing ring.
- Combustibility rating: UL94 – V0.
- Windspeed resistance grade: $\geq 240\text{Km/h}$.
- Light failure alarm or GPS is available if required.
- Mounting bracket is also available if required.

Specification

Description	Parameter
International standard	ICAO (Annex 14) medium intensity aviation obstruction light standard and FAA – L864
Light source	LED
Light color	Red
Vertical degree	$\geq 3^\circ$
Horizontal degree	360°
Operating voltage	AC110V ~ AC240V
Intensity	$2000 \pm 25\%$ cd
Working mode	Steady burning or flashing (optional)
Light source power	$\geq 60\text{W}$
Flashing duration	150ms ~ 1.5s (optional)
Power consumption	65W (steady burning)
LED lifetime	$\geq 100,000\text{hrs}$
On / off level	50lux (optional)
Flashing frequency	20 ~ 60 times / min
Ambient temperature	$-40^\circ\text{C} \sim +55^\circ\text{C}$
Humidity	10% ~ 95% (no coagulation)
IP Protection	IP65
Weight	9.5kg

LM401 Medium Intensity Aviation Obstruction Light



Application

For marking Towers (Telecom, GSM), Smokestacks, Buildings and any other potentially hazardous obstructions to air traffic.

Main Functions & Features

- Design Based on Fresnel lens optical principle .
- LED technology, extremely reliable and cost saving.
- Lamp housing – Polycarbonate, with good anti – impact strength, thermal stability, high transmittance.
- Base material – aluminum alloy base, anti-vibration, corrosion – resistant.
- External sealing material: waterproof seal.
- Combustibility rating: UL94 – V0.
- Wind rating: $\geq 49\text{m / s}$.
- Synchronization: GPS synchronization.
- Automatic Switching: luminous intensity switches with ambient light. automatically. Day $20000 \pm 25\%$ cd, night $2000 \pm 25\%$ cd.
- Can be customized accessories: mounting bracket.

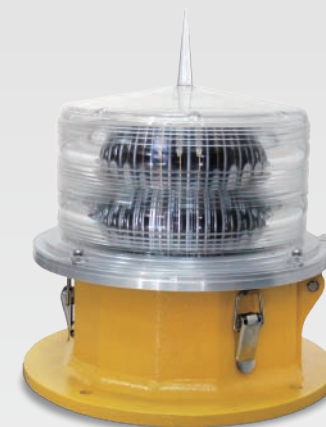

Specification

Description	Parameter
International standard	ICAO – Type A and FAA – L865
Color	white
Light source	LED
Intensity	Day $20000\text{cd} \pm 25\%$ cd
	Night $2000 \pm 25\%$ cd
Vertical degree	3°
Horizontal degree	360°
Working mode	Flashing
Operating voltage	AC110V ~ AC240V
Light source power	$\geq 400\text{W}$
Flashing rate	20FPM
Power consumption	Day $\leq 10\text{W}$
	night $\leq 10\text{W}$
LED lifetime	$\geq 100,000\text{h}$
Flashing duration	Day: 8ms
	Night: 110ms
On / Off level	50lux
Ambient temperature	$-40^\circ\text{C} \sim +55^\circ\text{C}$
Humidity	10% ~ 95% (no coagulation)
IP protection	IP65
Weight	9.5kg

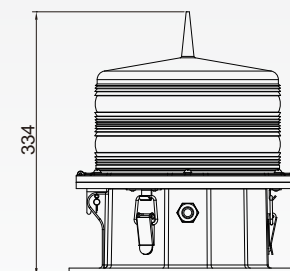
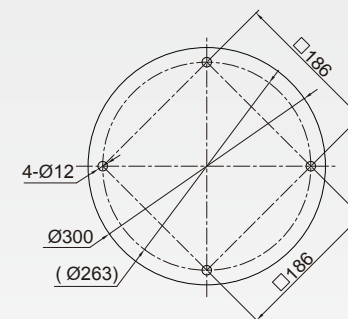



LS302 Dual Aviation Obstruction Light

Application

Obstruction light for a wide variety of cranes used in Harbors, Metallurgies, Towers (Telecom, GSM), Smokestacks, Buildings and any other potentially hazardous obstructions to air traffic with a steady burning red safety light.

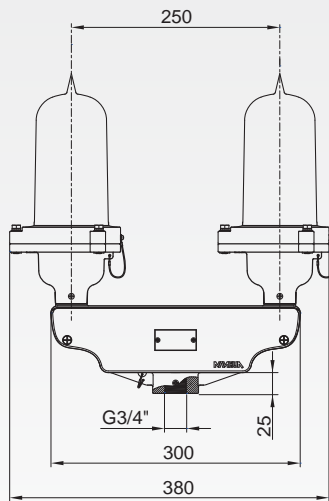

Main Functions & Features

- Die casting aluminum enclosure with powder – coat paint finishes, providing corrosion resistance and durability.
- Use LED cluster as bulb the lifetime is more than 100,000 hours.
- Self – contained compartment, with stainless steel wire which is used to secure the unit against falling in operation, and ease of mount.
- Sealed construction, can withstand the harsh effects of the environment.
- Built – in micro monitoring controller unit when and if the service light fails the controller switch on the standby light automatically (optional).
- Built-in photocell can switch ON / OFF the light at dawn and dusk (optional).
- Service and standby function (optional).
- Flashing mode or steady burning is available.
- Lamp housing – Polycarbonate, with good anti-impact strength, thermal stability, high transmittance.
- Extremely Reliable – Major Maintenance Cost Saving.

Specification

Description	Parameter
International standard	Compliant to the ICAO (Aerodromes Annex 14)
Light source	LED
LED color	Aviation red
Vertical degree	≥10°
Horizontal degree	360°
Flashing frequency	30 times / min
Operating voltage	AC110V~AC240V / DC40V~DC60V (optional)
Power consumption	<5W
Working mode	Steady burning or flashing mode
LED lifetime	≥100,000hrs
On/off level	50lux
Intensity	>10cd
Ambient temperature	-30°C ~ +70°C
Humidity	10% ~ 95% (no condensing)
IP protection	IP65
Material	Base: die casting aluminum; housing: PC
Weight	<4kg





LS308 Dual Aviation Obstruction Light



Application

Obstruction light for a wide variety of cranes used in Harbors, Metallurgies, Towers (Telecom, GSM), Smokestacks, Buildings and any other potentially hazardous obstructions to air traffic with a steady burning red safety light.

Main Functions & Features

- Die casting aluminum enclosure with powder-coat paint finishes providing corrosion resistance and durability.
- Use LED cluster as bulb, the lifetime is more than 100,000 hours.
- Self – contained compartment, with stainless steel wire which is used to secure the unit against falling in operation, and ease of mount.
- Sealed construction, can withstand the harsh effects of the environment.
- Built – in micro monitoring controller unit when and if the service light fails the controller switch on the standby light automatically (optional).
- Built – in photocell can switch ON / OFF the light at dawn and dusk (optional).
- Service and standby function (optional).
- Flashing mode or steady burning is available.
- Lamp housing – Polycarbonate, with good anti-impact strength, thermal stability, high transmittance.
- Extremely Reliable – Major Maintenance Cost Saving.

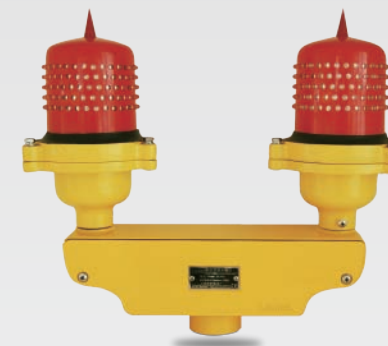

Specification

Description	Parameter
International standard	Compliant to the ICAO (Aerodromes Annex 14)
Light source	LED
LED color	Aviation red
Vertical degree	≥10°
Horizontal degree	360°
Flashing frequency	30 times / min
Operating voltage	AC110V~AC240V / DC40V~DC60V (optional)
Power consumption	8W
Working mode	Steady burning or flashing mode
LED lifetime	≥100,000hrs
On / off level	50lux
Intensity	>32.5cd
Ambient temperature	-30°C ~ +70°C
Humidity	10% ~ 95% (no condensing)
IP protection	IP65
Material	Base: die casting aluminum; housing: PC
Weight	< 4kg

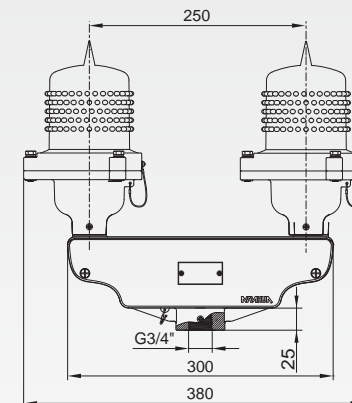



LS310C Low intensity dual aviation obstruction light

Application

Obstruction light for a wide variety of cranes used in Harbors, Metallurgies, Towers (Telecom, GSM), Smokestacks, Buildings and any other potentially hazardous obstructions to air traffic with a steady burning red safety light.

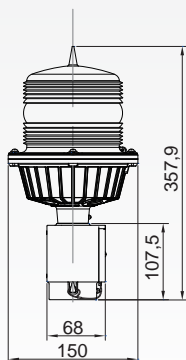
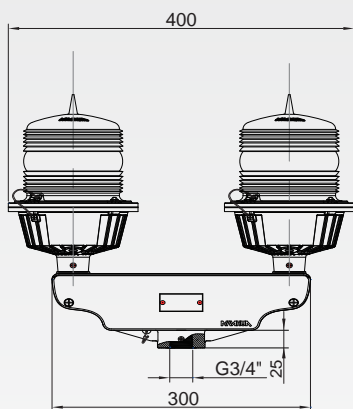

Main Functions & Features

- Use Fresnel lens, high utilization of light, valid keeping light beam in the scope as required.
- Based on LED technology, low power consumption, and high efficiency.
- Lamp housing – Polycarbonate, with good anti-impact strength, thermal stability, high transmittance.
- Aluminum alloy base with the advantage of light weight and corrosion resistance.
- G3/4" pipe is available, ease of mount.
- with stainless steel wire which is used to secure the unit against falling in operation, and ease of mount.
- Built – in micro monitoring controller unit when and if the service light fails the controller switch on the standby light automatically.
- Built – in photocell can switch ON / OFF the light at dawn and dusk (optional).
- With alarm signal output (optional).
- Extremely Reliable – Major Maintenance Cost Saving.

Specification

Description	Parameter
International standard	Compliant to the ICAO (Aerodromes Annex 14) and FAA – L810
Vertical degree	≥10°
Light source	High quality LED
Horizontal degree	360°
LED color	Aviation red(optional)
Flashing frequency	30FPM (20 ~ 60FPM / Steady burning)
Operating voltage	AC110 ~ 240V / DC48V (optional)
Flashing duration	150±20ms
Power consumption	6W (Steady burning) / 2W (30FPM)
LED lifetime	≥80,000hrs
Intensity	≥32.5cd
On / off level	500lux
Ambient temperature	-40°C ~ +70°C
Humidity	10% ~ 95% (no condensing)
IP protection	IP65
Material	Base: Aluminum alloy; Housing: PC; Reflector: ABS, vacuum aluminum film
Weight	4.5kg

LM212 Medium Intensity Aviation Obstruction Light



Application

For marking Towers (Telecom, GSM), Smokestacks (heat – engine plant, coking plant, chemical plant etc), Buildings, Port devise, Construction machinery, wind power generator etc for air traffic warning.

Main Functions & Features

- Based on LED technology and meets optics standard.
- Built – in circuit protect LED, extremely reliable and cost saving.
- Shockproof and corrosion resistant.
- Combustibility rating: UL94 – V0.
- When the bottom LED lights break down, the device will automatically turn on upper LED lights, along with alarm tone.

Specification

Description	Parameter
International standard	ICAO (Annex 14) medium intensity aviation obstruction light standard and FAA – L864
Light source	LED
LED color	Red
Vertical degree	3°
Horizontal degree	360°
Operating voltage	200 ~ 240VAC (other voltage can be customized)
Power consumption	30W (steady)
Lamp power	30W
Flashing frequency	30FPM (20 / 60FPM Aadjustable)
Flashing duration	150±20ms
LED Lifetime	≥100,000hrs
Intensity	2000cd±25%
Working type	Bottom lights working, top lights is spare
Ambient temperature	-40°C ~ +70°C
Humidity	10% ~ 95% (no coagulation)
IP protection	IP65
Material	Body: aluminum alloy; housing: PC; Reflector: ABS
Weight	5.5kg

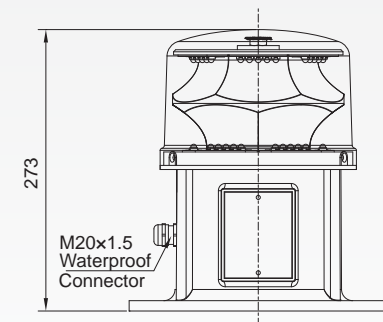
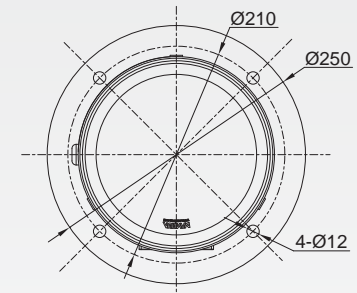



LT101 Solar Aviation Obstruction Light

Application

LT101 Solar Aviation Warning Light for Masts & Tower obstacles (Telecommunication, GSM, Radio & TV), tall cranes, chimney, tall buildings, sport stadiums, Light pylons, high voltage towers, wind generation and any other potentially hazardous obstructions to air traffic.

Main Functions & Features

- Based on LED technology.
- Base material – Die casting aluminum LM6, housing with polycarbonate with UV resistance and bird spike.
- Built-in photocell.
- Steel wire is used to connect base to housing against falling in operation.
- Built in NiMH battery, ease for replacement.
- No RF – radiations, EMC Compliant.
- Shockproof and corrosion resistance.
- Extremely Reliable – Major Maintenance cost saving.

Specification

Description	Parameter
International standard	ICAO (Aerodromes Annex 14) low intensity light TYPE – A
Light source	LED
Light color	Red, (Amber, Green, Blue, White Optional)
Horizontal degree	360°
Vertical degree	≥10°
Flash frequency	60time / min
Voltage	3.6V
Intensity	>10cd
LED Lifetime	≥100, 000hrs
On / Off level	70 / 100lux (switch)
Battery power consumption	1.8W
Continuous operation	7days
Battery Capacity	3.6V / 8AH (Maintenance – free) NiMH
Ambient temperature	-30°C ~ +70°C
Humidity	10% ~ 95%
IP Protection	IP65
Material	Base: aluminum Housing: PC
Weight	2.3kg

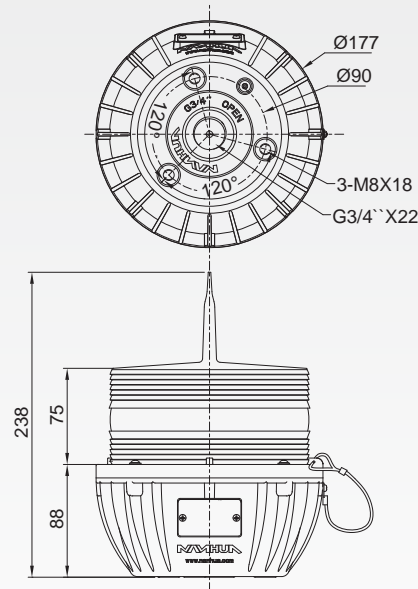

LT108 Solar Aviation Obstruction Light



Application

LT108 Solar Aviation Warning Light for Masts & Tower obstacles (Telecommunication, GSM, Radio & TV), tall cranes, chimney, tall buildings, sport stadiums, Light pylons, high voltage towers, wind generation and any other potentially hazardous obstructions to air traffic.

Main Functions & Features

- Meets optics standard.
- Extremely reliable and cost saving.
- Shock – proof and corrosion resistant.
- Combustibility rating: UL94 – V0.
- Wireless control (Optional) .

Specification

Description	Parameter
International standard	ICAO (Annex 14) Low intensity aviation light and FAA standard
Light source	LED
LED color	Red
Vertical degree	$\geq 10^\circ$
Horizontal degree	360°
Power supply	DC12V
Power consumption	8W
Light source power	8W
Flashing frequency	30time / min
Flash duration	150ms
LED Lifetime	$\geq 100,000$ hrs
On / Off level	70 / 100lux
Intensity	>32.5 cd
Solar panel type	Monocrystalline silicon
Battery type	Lead – acid battery
Battery lifetime	One year
Solar panel power	12W
Battery	12V 7AH
Autonomy	5 days
Ambient temperature	$-40^\circ\text{C} \sim +70^\circ\text{C}$
Humidity	10% ~ 95% (no coagulation)
IP protection	IP65
Material	Body: aluminum alloy; Housing: PC; Reflector: ABS
Weight	5.5kg

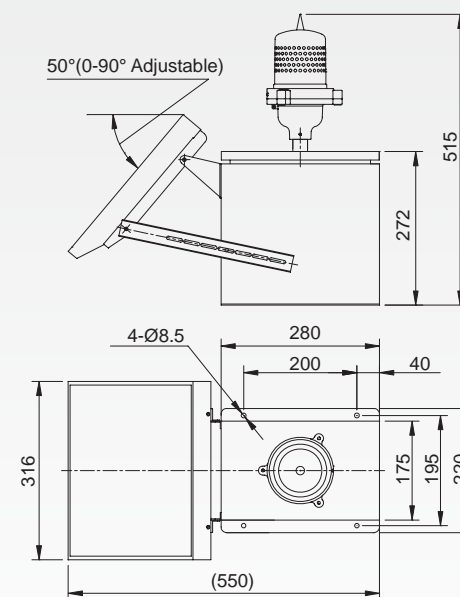

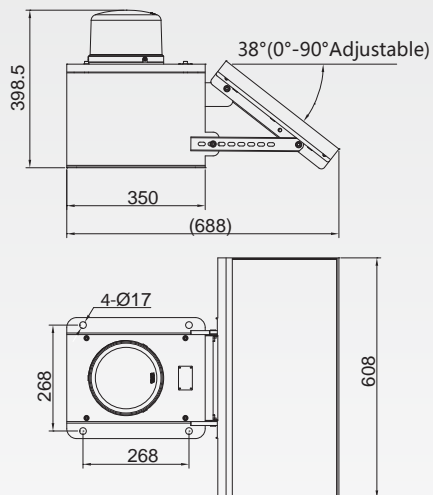
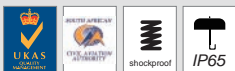

LT506 Medium Intensity Solar Aviation Obstruction Light

Application

LT506 Medium intensity solar obstruction light for marking Towers Telecom, GSM), Smokestacks (heat – engine plant, coking plant, chemical plant etc), Buildings, Port devise, Construction machinery, wind power generator etc for air traffic warning.

Main Functions & Features

- Meets optics standard.
- Based on LED technology, extremely reliable and cost saving.
- Shock – proof and corrosion resistant.
- Built – in connect terminals, and connected well inside before Ex – work.
- Combustibility rating: UL94 – V0.
- Highlight LED, LED lifetime more than 100,000hrs.

Specification

Description	Parameter
International standard	ICAO; FAA – L864
Light source	Highlight LED
LED color	Red
Vertical degree	3°min
Horizontal degree	360°
Power supply	24W silicon solar panel 12V 33AH lead – acid battery
Power consumption	30W
Flashing frequency	20times / min
Flash duration	150±20ms
LED Lifetime	≥100,000hrs
On / Off level	70 ~ 100 lux
Intensity	2000 ± 500cd
Ambient temperature	-30°C ~ +70°C
Humidity	10% ~ 95% (no condensing)
IP protection	IP65
Material	Enclosure: Stainless steel; Base: Aluminum alloy; Housing: PC; Reflector: ABS
Weight	32kg

LT810 Solar Aviation Obstruction Light



Application

Obstruction light for a wide variety of cranes used in Harbors, Metallurgies, Towers (Telecom, GSM), Smokestacks, Buildings and any other potentially hazardous obstructions to air traffic with a steady burning red safety light.

Main Functions & Features

- Extremely Reliable – Major Maintenance Cost Saving.
- Corrosion resistance and durability.
- Use NiMH battery, easy to replace.
- Lamp housing – Polycarbonate, with good anti-impact strength, thermal stability, high transmittance.
- Combustibility rating: UL94 – V0.

Specification

Description	Parameter
International standard	ICAO (Annex 14) low intensity aviation light and FAA – L810
Light source	LED
LED color	Red
Vertical degree	≥10°
Horizontal degree	360°
Intensity	>32.5cd
Flashing frequency	20 or 30 or 40 times / min (adjustable) Default rate: 30times / min
Led lifetime	≥100.000hrs
On / off lever	70 / 100Lux
Battery capacity	3.6V / 8AH NiMH
Solar panel	4W / 5V
Autonomy	7 days (at 25°C, if the temperature is lower than 0°C or above 40°C, it will affect the battery discharge)
Ambient temperature	-40°C ~ +55°C
Humidity	10% ~ 95% (no coagulation)
IP protection	IP65
Material	Base: die casting aluminum; Housing: PC
Weight	5kg

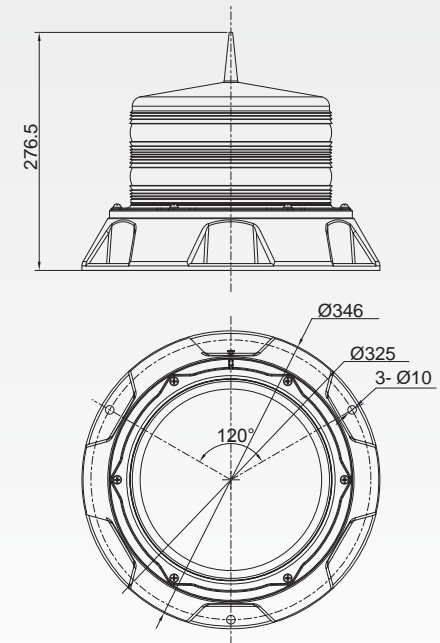



LT901 Solar Warning Light

Application

Apply to construction machinery(travelling cranes, crawler crane, RTG cranes etc.), harbor machinery(bridge cranes, STS cranes)etc heavy machinery or port, quay such area request warning indicator.

Main Functions & Features

- Base material is Nylon and housing is PC, anti-ultraviolet
- Photoelectric automatic controlled
- Internal Ni-MH battery
- No RF, no electromagnetic interference, work stability
- Shockproof and corrosion resistance
- Three installing types for selection

Specification

Description	Parameter
Light source	LED
Color	Red
Working mode	Flash
Frequency	40±10 times / minute
Solar cell	0.3W monocrystalline silicon solar cell
Battery	1.2V/1.8AH (Maintenance-free) Ni-MH
Continuous operation	5 days
Peak intensity	5cd
Battery protection way	Bottom dormancy switch (see notice)
Ambient temperature	-40°C ~ +55°C
IP protection	IP65
Humidity	10% ~ 95% (no condensing)
Material	Base: Nylon; Housing: PC
Weight	0.4kg
Control type	Optically controlled



Flange Mounting

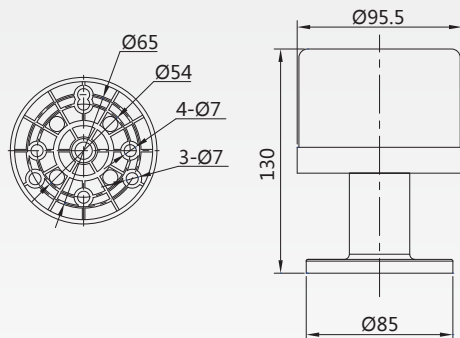

Surface mounting



Magnetic steel mounting

ML201A Solar Marine Navigation Light



Application

Ideal for hazard marking, aquaculture, navigation, perimeter lighting & a host of other applications.

Main Functions & Features

- Based on LED technology, and its color complies to IALA Recommendations E – 200 – 1.
- Integrated design, enabling a rugged and completely waterproof seal capable of prolonged and deep immersion (IP68).
- PC housing, UV resistance, shockproof and corrosion proof.
- With birds pike.
- 256 kinds of flashing rate are available, comply with IALA.
- Intensity can be adjusted from 25%, 50%, 75% and 100% of total intensity.
- With photocell, and manual switch.
- With Steel wire to prevent falling during mounting and adjusting.
- With built in NiMH battery, easy for replace.
- No RF – radiations, EMC Compliant.
- Extremely Reliable and cost saving.

Specification

Description	Parameter
Intensity	10cd
Visible Range	>2.5mm
Available colors	Red, amber, green, blue, white
Vertical degree	>9 °
Horizontal degree	360 °
Light source	LED
LED lifetime	≥100,000 hrs
Autonomy	>20 days (12hour darkness, 12.5% duty cycle)
On / off level	300 lux ± 100lux
Flashing frequency	Complies to IALA Recommendations, total 256 available flashing rate (available steady burning)
Solar module type	Multicrystalline
Output	1.8 Watts
Battery type	High grade NiMH – Environment friendly
Battery capacity	3.6V / 8 AH
Integrated housing	UV resistance PC
IP protection	IP68
Weight	1.7 KG
Ambient temperature	-30°C ~ +70°C
Size	H: 170mm, D: 228mm
Mounting dimension	Φ200 – 4XM6
Customized	External power or Infrared control

* IALA International Association of Lighthouse Authorities is a non-profit, non-governmental international technical association. Established in 1957, it gathers marine aids to navigation authorities, manufacturers and consultants from all parts of the world and offers them the opportunity to share their experiences and achievements.

* IP 68 is the highest level of connector waterproof standard.

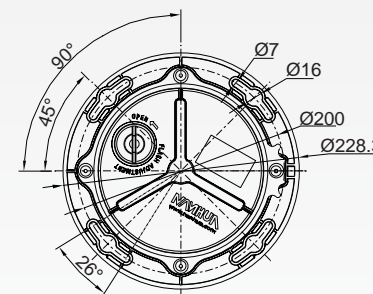
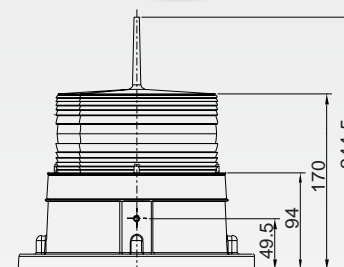
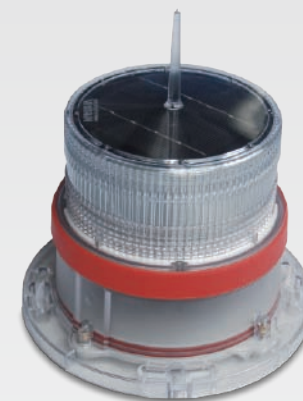



ABC-707 Photoelectric Switch Control Box

Application

Control box for monitor lighting operation system for the following failures:
burned out lamp and power failure.

Main Functions & Features

- Made by stainless steel with sealed structure, waterproof and shockproof.
- Controlled by special circuit, to prevent disoperation.
- When triggered, power indicator will light up.
- In case of emergency, switch to "manual position"; otherwise switch to "automatic position". (Emergency switch has been set to "automatic position" before sending out.).

Specification

Description	Parameter
Operating voltage	AC110V ~ AC240V / AC380V
	DC12V ~ DC24V
Frequency	50Hz ~ 60Hz
Load wattage	200W
Ambient temperature	-30°C ~ +70°C
Humidity	10% ~ 95% (no coagulation)
IP protection	IP65
Material	Cold rolled steel with powder painting
	/ Stainless steel
Weight	3.5kg

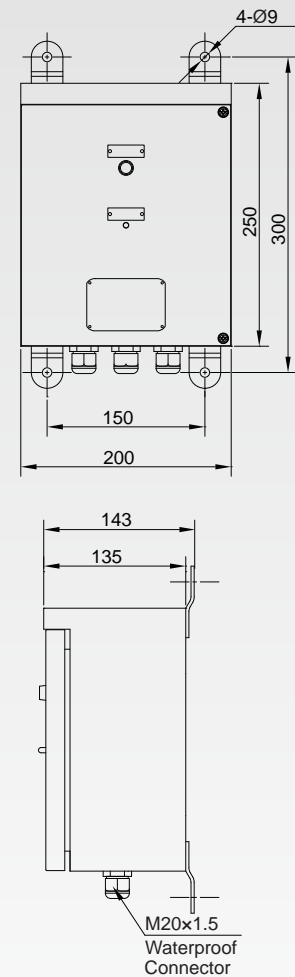

ABC-7A LED Bulb

Application

Obstruction light for a wide variety of cranes used in Harbors, Metallurgies, Towers (Telecom, GSM), Smokestacks, Buildings and any other potentially hazardous obstructions to air traffic with a steady burning red safety light.

Main Functions & Features

- Based on LED technology.
- Lamp housing – Polycarbonate, with good anti – impact strength, thermal stability, high transmittance.
- Low power consumption, high efficiency, low heat and stability.
- Screwed type, convenient to mount.

Specification

Description	Parameter
International standard	ICAO (Aerodromes Annex 14) (Type A) and FAA – L810
Light source	LED
Light color	Red, yellow, blue, green and white (optional)
Horizontal degree	360°
Vertical degree	≥10°
Operating voltage	AC110V ~ AC240V / DC12V ~ DC48V (optional)
Working mode	Steady burning or flashing mode
Power consumption	<5W
Intensity	>10cd
Led lifetime	≥100,000hrs
Ambient temperature	-30°C ~ +70°C
Relative humidity	10% ~ 95% (no condensing)
IP Protection	IP65
Material	Base: ABS; Housing: PC
Weight	0.14kg

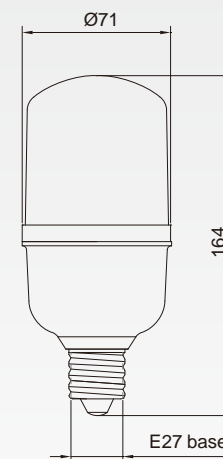



Outdoor type

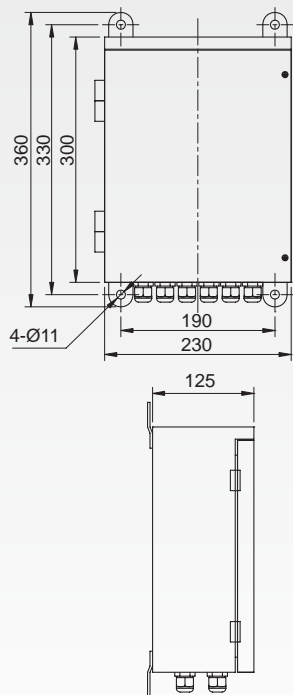

FR151U / FR151W Synchronizing Control Box

Application

FR151U / FR151W controller design for the fault alarm output, ON / OFF and flash frequency control for Aviation obstruction light, and can also used for street lamp control.

Main Functions & Features

- Control the aviation lights flash synchronously.
- With fault alarm when any light failed will with alarm indicator and fault signal output.
- Alarm signal output, the signal with relay contactor output, no power source.
- With a manual photocell switch, can switch ON / OFF the light when the photocell is not available.
- Photocell – PJ003.

Specification

Description	Parameter
Operating voltage	DC48V / AC220V
Alarm output ways	4 ways
Control circuit branch	4 ways
Photocell sensitivity	70 ~ 100Lux (On / Off)
Flash frequency	20 ~ 60times / sec (adjustable)
Alarm output	One way dry connect (relay) output
Control method	Steady burning / flash
Ambient temperature	-30°C ~ +70°C
Humidity	10% ~ 95% (no coagulation)
IP Protection	IP65
Material	Indoor type: ABS; outdoor type: cold rolled steel / stainless steel (optional)
Weight	Indoor type: 0.5Kg; Outdoor type: 5.5Kg

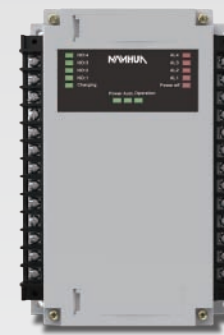

Indoor type

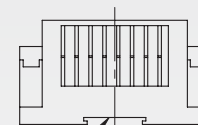

This place can match 35MM width's aluminum rail

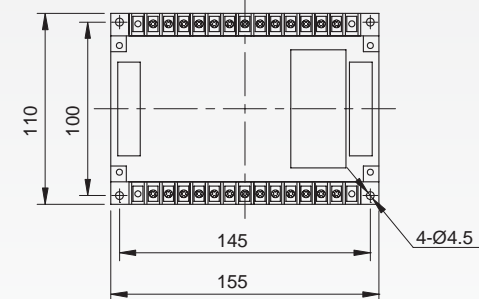
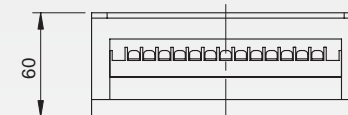

FR191W Control Box



Application

FR109 Control Box can give alarm when light fault, control light flashing frequency and on / off at dusk / dawn, also can be used in street light.

Main Functions & Features

- Control all the light flashing at the same time.
- Individual alarm signal and LED indicator shows corresponding light working state.
- Alarm output passive signal.
- Automatic/override manual are available, if in override state, the light will not control by photocell.
- Alarm output when outdoor photosensor fault.

Specification

Description	Parameter
Operating Voltage	AC110V ~ AC240V
Max. alarm output	9
Max. control light	8
Flash frequency	30 ~ 60 times / min (adjustable)
Photocell sensitivity	70~100Lux (on/off)
Alarm output	Dry contact
Control mode	Steady burning / flashing
Temperature	-30°C ~ +70°C
IP Protection	IP65
Humidity	10% ~ 95% (no condensing)
Weight	10 ± 0.5 Kg
Material	Enclosure: Cold rolled steel

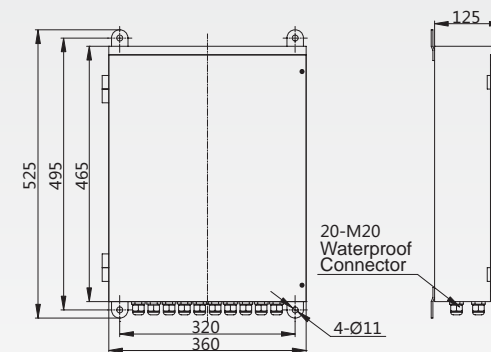

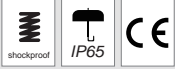

ABC-16D

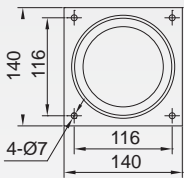
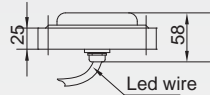

ABC-16

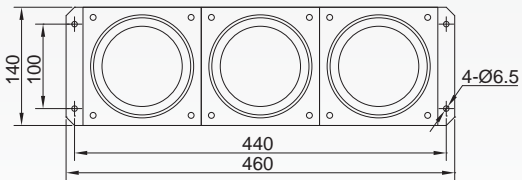
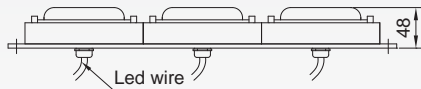

ABC-16C

ABC-16 Spreader Indicator

Application

Specially design for all kinds of hoisting machinery.

Main Functions & Features

- Lamp body constructed of die cast aluminum, light weight, corrosion resistance, sealed, waterproof and dustproof.
- Super bright LED design, lifetime more than 100,000hrs.
- Flexible combination mode for wide application

Specification

Description	Parameter
Operating voltage	AC110V ~ AC240V / DC12V / DC24V / DC48V
Power consumption	≤5W
Frequency	50Hz ~ 60Hz
Color	Red, yellow, green, blue, white (optional)
Visible distance	>300m
Wiring type	Cable / plug (optional)
LED Lifetime	≥100,000hrs
Lead wire length	8m
Ambient temperature	-30°C ~ +70°C
Humidity	10% ~ 95% (no condensing)
IP Protection	IP65
Material	Main body: Aluminum alloy

Model	Combination type	Electric current	Wiring type	Weight (kg)
ABC-16	General	<300mA	One 8m Three-core cable	1.5
ABC-16A	Four-core cable	<300mA	Four-core blug	1
ABC-16B	2 lights	<500mA	Two 8m Three-core cable	3.8
ABC-16C	3 lights	<700mA	Three 8m Three-core cable	5.7
ABC-16D	4 lights	<1A	Four 8m Three-core cable	7.6
ABC-16E	5 lights	<1.2A	Five 8m Three-core cable	9.5
ABC-16F	Four-core cable and grind glass	<300mA	Four-core blug	1
ABC-16FA	8m cable and grind glass	<300mA	One 8m Three-core cable	1.5

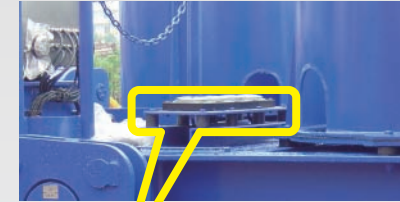

ABC-18 Arrow indicator



Application

Specially design for all kinds of harbors machinery, engineering machinery and hoisting machinery or road traffic directions.

Main Functions & Features

- Main body use cold rolled steel with powder coat paint finishes providing environmental protection, corrosion resistance and maintenance free.
- Super bright LED cluster as bulbs, providing external long life.
- Air plug (YD28KZTP) and air socket (YD28J4ZTP) as connector, ease installation and wide application.
- Adopt transparent safety glass as front panel, providing high transmittance and firmly seated.
- Two arrowhead indicators on one display, three indicator states, easy operation.

Specification

Description	Parameter
Operating voltage	DC24V
Power consumption	<24W
Electric current	<1A
Color	Red
Visible distance	≥200m
Cable length	1.5m
LED Lifetime	≥100,000hrs
Ambient temperature	-30°C ~ +70°C
Humidity	10% ~ 95% (no condensing)
IP Protection	IP65
Material	Main body: Cold rolled steel + powder coat
Weight	32kg

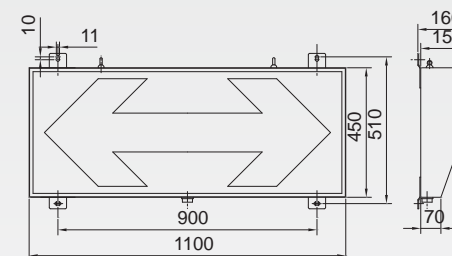



ABC-2 / ABC-3 LED Triple Light Indicator



Application

Special designed for various travelling cranes and hoist, to check the power of an equipment or device when a problem occurs.

Main Functions & Features

- Employ cold rolled steel enclosure with powdercoat paint finishes, providing durability and corrosion resistant.
- Use super bright LEDs as bulb, providing external long life.
- Completely sealed by silicon rubber glue, providing high IP protection.
- Flexible mounting mode, Lamp no. and color can be customized based on the customer's special requirement, for wide application.

Specification

Description	Parameter
Operating voltage	AC220V / AC380V (Special voltage can be customized)
Rating power	<8W (each lamp)
Frequency	50Hz ~ 60Hz
Lamp color	Red, amber, green, blue or white (optional)
Visible distance	>300m
Working mode	Steady burning
Life time	100,000hrs
Wiring	Y - connection
Ambient temperature	-30°C ~ +70°C
Humidity	10% ~ 95% (no condensing)
IP Protection	IP65
Material	Cold rolled steel / stainless steel304 (optional)
Weight	See below model selection table

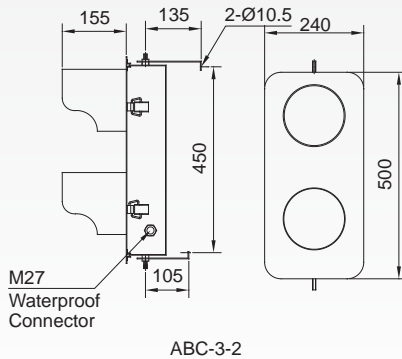
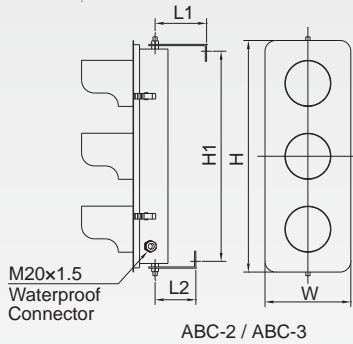

Model	H	H1	L1	L2	W	Dia. Of Lamp pane	Waterproof Connector	Feature	Weight (kg)
ABC-2	540	480	120	95	200	Φ100	M20	Normal	5.9kg
ABC-2B	540	480	120	95	200	Φ100	M20	Stainless steel enclosure ABC-2	5.9kg
ABC-2W	540	480	120	95	200	Φ100	M25	ABC-2 outdoor type	5.9kg
ABC-2S	540	480	120	95	200	Φ100	M20	ABC-2 flash type	5.9kg
ABC-2F	300	260	70	70	115	Φ52	M20	normal	2.6kg
ABC-2F1	300	260	70	70	115	Φ52	M20	AC460V ABC-2F	2.6kg
ABC-2A	300	260	70	70	115	Φ52	M20	Stainless steel inclosureABC-2F	2.6kg
ABC-3	640	480	120	95	240	Φ140	M20	Normal	7.2kg
ABC-3T	640	480	120	95	240	Φ140	M20	Superlight ABC-3	7.2kg
ABC-3A	640	480	120	95	240	Φ140	M20	Arrow	7.2kg
ABC-3H						Φ140	M20	Level mount ABC-3A	7.2kg
ABC-3-2						Φ140	M27	Combined with two lights ABC-3	7.3kg
ABC-3-4						Φ140	M27	Combined with four lights ABC-3	9.9kg
ABC-2-8						Φ100	M25	AC3000V ABC-2 indoor type	9.5kg
ABC-H2						Φ100	M20	With alarm function ABC-2	5.7kg
ABC-2-2						Φ100	M20		2.5kg

ABC-401 Clear Alternative Integrated

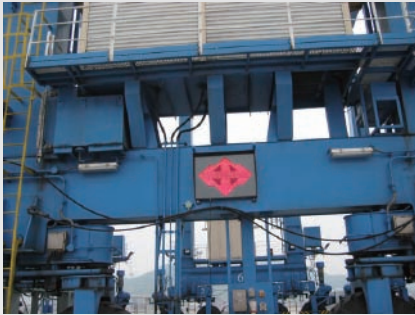

Application

Specially design for variety of large – scale port machinery, engineering machinery, cranes and other machinery road traffic directions.

Main Functions & Features

- Employ stainless steel with powdercoat paint finishes enclosure providing environmental protection, corrosion resistance and maintenance free.
- Use super bright LED cluster as bulbs, providing external long life.
- Transparent safety galss as front panel, providing high transmittance and firmly sealed.
- Four arrowheads direct four states, easy of operation.

Specification

Description	Parameter
Operating voltage	DC24V (special voltage can be customized)
Power consumption	75W
LED Color	Red (special color can be customized)
LED Lifetime	≥100,000hrs
Visible distance	>200m
Ambient temperature	-30°C ~ +70°C
Humidity	10% ~ 95% (no condensing)
IP protection	IP65
Material	Stainless steel
Weight	35.5Kg

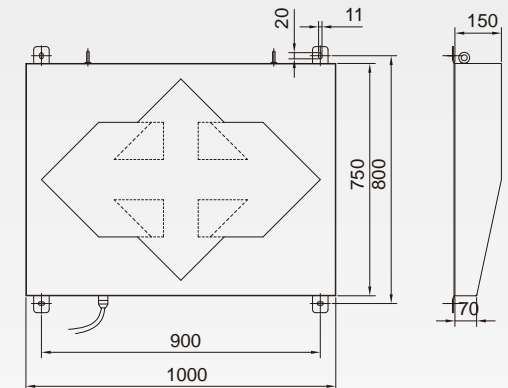
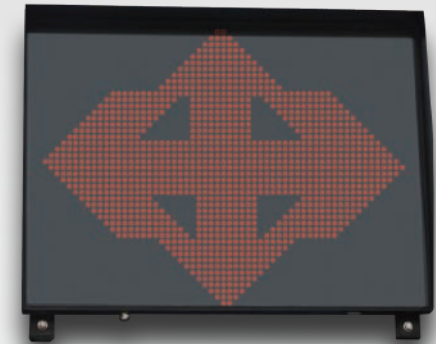



LD302 LED Display

Application

Specially designed for heavy machinery, engineering machinery and cranes etc.

Main Functions & Features

- Wide range applicable environment, Ambient temperature $-30^{\circ}\text{C} \sim +70^{\circ}\text{C}$, Relative humidity: 95%.
- RS485 data communication, electromagnetic compatibility and anti-jamming.
- Stainless steel cover box, strong and durable.
- Ultra-bright outdoor LED module, high luminance, wide angle, no reflection.
- Use wiring box, access line through gland box, convenient and flexible installation.
- Sealed structure, waterproof, shockproof, meet IP65 industrial standard.

Specification

Description	Parameter
Operating voltage	AC100V ~ AC250V
Visible angle	$>120^{\circ}$
Frequency	50 - 60Hz
Display color	Red / green / Yellow
Visible distance	1000m
Data line	Twisted pair wiring
Communication mode	RS485
Wiring	M27 cable gland*2
Image definition	16X16
Pixel	$\Phi 5$
Ambient temperature	$-30^{\circ}\text{C} \sim +70^{\circ}\text{C}$
Humidity	10% ~ 95% (no condensing)
IP protection	IP65
Material	Stainless steel
Weight	10kg

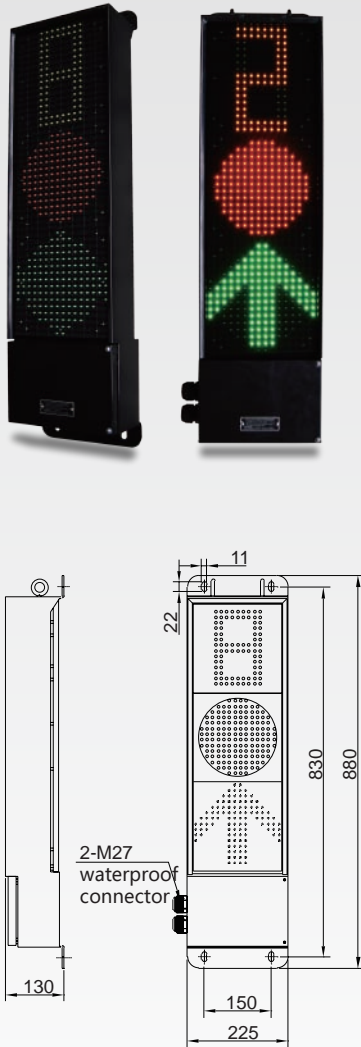

ABC-30A LED Light Bar



Application

Can be used in harsh environments as auxiliary lighting (waterproof, corrosion protection and shockproof). Such as using in large scale port machinery's (Tire hoists, Cranes, Gantry Cranes, etc) driver cab and walkway lighting; wind turbine (Nacelle, Tower cylinder, Wheel drums) interior lighting; ship overhead and walkway lighting.

Main Functions & Features

- Based on LED technology, it features high luminance, low power consumption, external long life and can replaced fluorescent light.
- Reliance built – in switching power.
- Sealed structure, waterproof and shockproof.
- Mounting angle 15°, with power terminals for wiring out, convenient for connecting to other lamps.
- There are two materials: Engineering Plastics PA6+30% Glass fiber or Aluminum.
- There are many mounting solutions can be chosen.

Specification

Description	Parameter
Operating voltage	AC110V ~ 240V / DC24V / DC48V
Rated wattage	<10W
Frequency	50Hz ~ 60Hz
LED Lifetime	≥100,000hrs
Ambient temperature	-30°C ~ +70°C
Humidity	10% ~ 95% (no condensing)
IP protection	IP65
Material	Case: Aluminum Panel; Engineering Plastics +Glass fiber
Weight	1.8kg

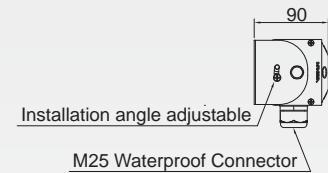
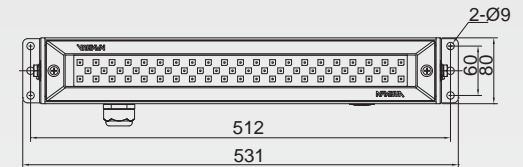

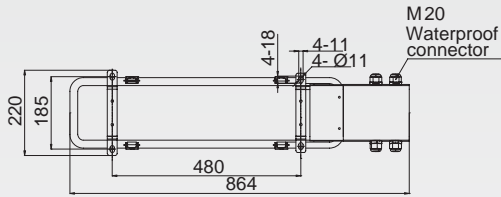

LY410 & LW410A & LY410A & LW410A

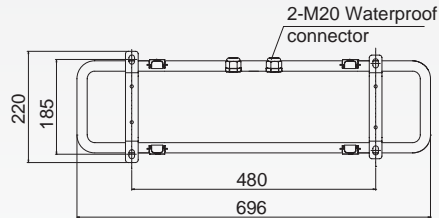
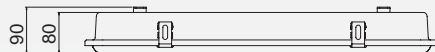
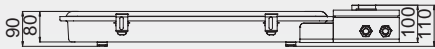

LY410B & LW410B

LW410 / LY410 LED Light

Application

Design for wind gerator (cabin, vessel, hub) inside lighting, and additional lighting for hazardas enviornment(waterproof, corrosion resistant, shockproof etc).

Main Functions & Features

- Soft light beam.
PC grain housing makes the light beam softly, to protect eyes.
- External long life, energy saving and environmental friendly
The life of LED can reach more than 100,000hrs, and the light can save 50% energy than common bulb, maintenance free.
- Integrated design, convenient for mount.
Lamp body and junction box are combined together on a base, convenient for mount and maintenance.
- Selectable plug, terminals and cable gland (see model selection) .
Equipped with standard 16A power plug, other type of plug can be selected as request.
No. of terminals and cable gland can be customized based on request.
- Emergency function (suitable for LY410 series) .
In case of power failure, emergency duration is more than 90mins.

Specification

Description	Parameter
Operating voltage	AC100V ~ 240V
Power consumption	General: 14W; Emergency: 19W
Frequency	50Hz ~ 60Hz
LED life	≥50,000hrs
Color temperature	6000K ~ 7000K
LED luminance	100lm / W
Color rendering index	Ra72
Lighting angle	>200°
Working temperature	General: -40°C ~ +50°C Emergency normal temperature: -10°C ~ +40°C Emergency low temperature: -30°C ~ +40°C
Ambient temperature	-40°C ~ +70°C
Humidity	10% ~ 95% (no condensing)
IP protection	IP44 (with plug) (IP65plug available) IP65 (without plug)
Material	Housing: PC; Base: cold rolled steel with coating

Model	LY410	LW410	LY410A	LW410A	LY410B	LW410B
Plug function	available	available				
Plug model	10A plug	10A plug				
Emergency function	available		available		available	
Emergency duration	90 min		90 min		90 min	
Terminals	available	available	available	available	non	non
Terminals no	16	16	6	6	1	1
Cable gland no.	4	4	4	4	2	2
Weight	4.8Kg	4.6kg	4.8kg	4.6kg	3.6kg	3.5kg

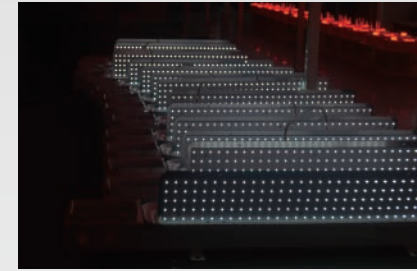

LW420 LED Light



Application

Designed for wind turbine (tower, nacelle) inside lighting and other harsh environment (For those need waterproof, corrosion resistant, shockproof applications).

Main Functions & Features

- Soft light beam.
PC grain housing makes the light beam softly, to protect eyes.
- External long life, energy saving and environmental friendly.
The life of LED can reach more than 50,000hrs, and the light can save 50% energy than common bulb, maintenance free.
- Compact structure and size, light weight, switchable mounting hole, easy for mounting on site.

Specification

Description	Parameter
Operating voltage	AC100V ~ 240V
Power consumption	13W
Frequency	50Hz ~ 60Hz
LED Lifetime	≥50,000hrs
Color temperature	5500K ~ 6000K
LED luminance	100lm / W
Color rendering index	Ra>70
Lighting angle	>200°
Storage temperature	-40°C ~ +70°C
Ambient temperature	-40°C ~ +50°C
Humidity	10% ~ 95% (no condensing)
IP protection	IP65
Material	Housing: PC; Base: Aluminum
Weight	1.3kg

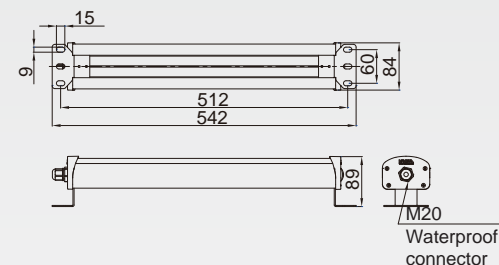



LW430A LED Light

Application

Designed for wind turbine (tower, nacelle) inside lighting, and additional lighting for hazards environment (Waterproof, corrosion resistant, shockproof).



Main Functions & Features

- Soft light beam.
PC grain housing makes the light beam softly, to protect eyes.
- External long life, energy saving and environmental friendly.
The life of LED can reach more than 50,000hrs, and the light can save 50% energy than common bulb, maintenance free.
- Compact structure and size, light weight, switchable mounting hole, easy for mounting on site.

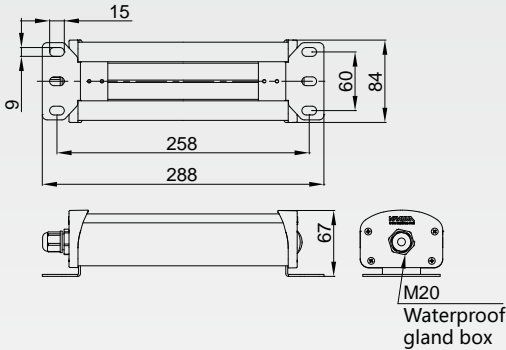

Specification

Description	Parameter
Voltage	AC100V ~ 240V
Frequency	50Hz ~ 60Hz
Power consumption	10W
LED lifetime	≥50,000 hrs
Color temperature	5500K ~ 6000K
Color rendering index	Ra>70
LED luminance	100lm/W
Lighting angle	>170°
Ambient temperature	-40°C ~ +50°C
Storage temperature	-40°C ~ +70°C
Humidity	10% - 95% (no condensing)
IP protection	IP65
Material	Housing: PC; Base: Aluminum strips
Weight	1.0KG

As Series multi – function Alarm

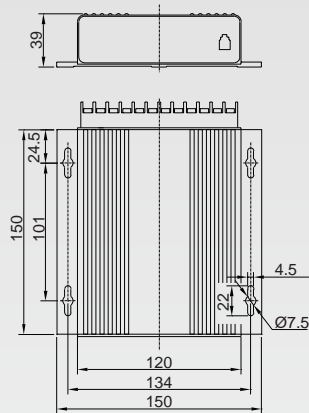

Application

Used in the cabs of engineering machinery (travelling cranes, crawler cranes, truck cranes and etc.), port machinery (gantry crane, overhead travelling cranes and etc.).

Main Functions & Features

- Speaking prior to alarm.
- Volume adjustable.
- Microphone & Loudspeaker available.
- Various tones to choose from.
- Visible and audible alarm synchronous (optional).
- Power off memory can hold the setting data.
- Several kinds of combination mode for choose.
- Nice appearance, convenient operation.

Specification

Description	Parameter
Operating voltage	AC110V ~ AC240V
Frequency	50 ~ 60Hz
Alarm tone	A, B, E (customized available)
Standard	GB /8108 – 1999
dB	106dB~110dB
Output carrier power	200W
Ambient temperature	-30°C ~ +60°C
Humidity	10% ~ 95% (non – condensing)
Material	Aluminum alloy
Weight	1.5kg



AS210 / AS211 / AS212



SS-A handset



SE gooseneck microphone



YH25-3 loudspeaker



YH10-2 loudspeaker

Model	Output wattage	Speaker	Microphone
AS210	10W	YH10-2 10W / 8Ω	handset /gooseneck
AS211	25W	YH25-3 25W / 16Ω	gooseneck
		YH25-3 25W / 16Ω*2	/handset
AS212	50W	YH50-3 50W / 16Ω*2	gooseneck /handset

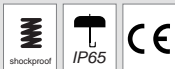

AL223



AL203

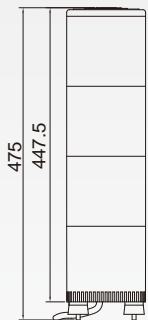
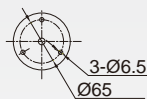
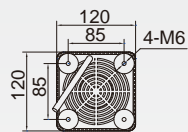

AL223

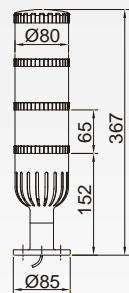

AL203

AL223 / AL203 LED Tower light

Application

Specially design for various cranes used in harbors, metallurgies and coalmines.

Main Functions & Features

- Three light colors, emergency sounds and led displays to indicate operation status for selection.
- Strong anti – electromagnetic interference ability. Controlled by digitalchip.
- Giving emergency sound and alert light at the same time, providing continuous operation.
- Waterproof, Shockproof, Corrosion resistance.
- Lamp house can make 1 – 4 level overlying.

Specification

Description	Parameter
Operating voltage	DC24V
Tone	D / Y (Optional)
Color	Red / Yellow / Green
Rated current	<0.5A
Sound level	110dB
Power consumption	8W
Humidity	10% – 95% (no condensing)
IP protection	IP65
Installation	Using 4 Nos. M6 screws
Way of working	Continuation
Weight	1.4kg
Material	Base: ABS; Housing: PC

Type	Characteristic
AL222	2- Level, Light and voice
AL223	3-Level, Light and voice
AL224	4-Level, Light and voice
AL203	Roundness, 3-Level, Light and voice
AL213	Roundness, 3-Level, no voice

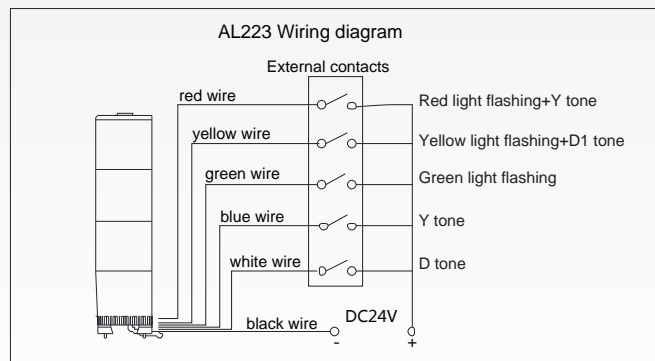

BC-110 Outdoor Siren and Revolving Light



Application

Specially design for all kinds of hoisting machinery (tyre crane, crawler crane, overhead traveling cranes, etc.), harbors machinery (gantry cranes, bridge crane, etc), Plant (electrotechnical box), metallurgies, chemical industry, coalmines and marine etc.

Main Functions & Features

- Die casting aluminum enclosure, with good appearance and corrosion resistance and good sealed performance, with good water – proof and dust – proof .
- Specially designed integrated core, with super strong EMI performance.
- PC housing – UV resistance, high transmittance, anti-aging and impact resistance.
- Vacuum Reflector improves the diffusion of the signal beam greatly.
- Several sounds available, and adjustable sound volume.
- High power speaker, suitable for noisy places.



Specification

Description	Parameter
Operating voltage	AC24V / AC36V / AC110V / AC220V AC380V / DC24V (can be customized)
Tone	Ring, A, B, E, D, Speech (optional)
Frequency	50Hz ~ 60Hz
Speaker power	25W / 50W
Color	Red, yellow or green (optional)
Sound level	110dB
Alarm method	Audio and visual alarm at the same time
Operating temperature	-30°C ~ +70°C
Humidity	10% ~ 95% (no condensing)
IP protection	IP65
Material	Die casting aluminum
Weight	≤6.8Kg

Model	Tone	Source
BC-110	A	Bulb
BC-110F	Music or voice	Bulb
BC-110A	A/B	Bulb
BC-110L	A	LED light source

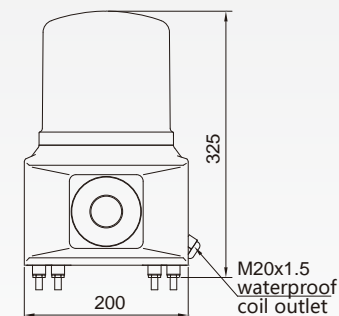
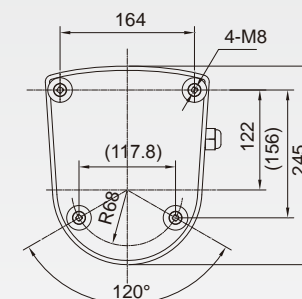



BC-3B / BC-3BF

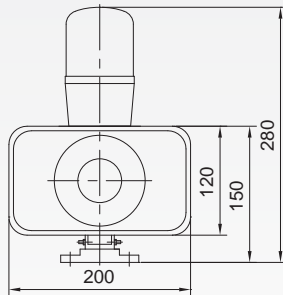
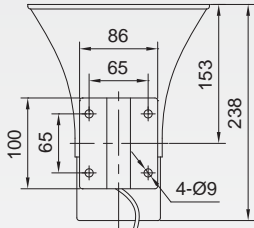

BC-3B / BC-3BF Beacon Siren

Application

BC-3B beacon siren specially designed for construction machinery (traveling cranes, crawler crane, rubber tyred gantry crane), port machinery (gantry cranes, bridge cranes) etc hoist devise for visible & audible warning.

Main Functions & Features

- Visible & audible warning.
- Multiple alarm tones for selection.
- Visible alarm light uses long lifetime LED.
- Nice appearance, ease of use.
- Can connect to external junction box.

Specification

Description	Parameter
Operating voltage	AC220V / DC24V (other voltage can be customized)
Frequency	50Hz ~ 60Hz
Tone	A / B / E (optional)
Speaker power	10W
Color	Base: red Housing; red / yellow (optional)
Sound level	106dB
Warning method	Visible & Audible
Speaker resistance	8Ω
Ambient temperature	-30°C ~ +70°C
IP protection	IP65
Humidity	10% ~ 95% (no coagulation)
Material	Base: ABS; Housing: PC
Weight	1.8kg

Model	Light	Weight	Remark
BC-3A	No	1.6kg	
BC-3B	LED	1.8kg	
BC-3BF	Xenon tube	1.8kg	Flicker frequency 1Hz



BC-6 Beacon Siren



Application

Specially design for all kinds of hoisting machinery (tyre crane, crawler crane, overhead traveling cranes, etc.), harbors machinery (gantry cranes, bridge crane, etc), Plant (electrotechnical box), metallurgies, chemical industry, coalmines and marine etc.

Main Functions & Features

- Loud and clear sound.
- Apply led bulb, with high efficiency, low power consumption and external long life.
- Give audible and visual alarm at the same time.
- Special sound can be customized based on request.

Specification

Description	Parameter
Operating voltage	AC220V / DC24V (optional)
Power frequency	50Hz ~ 60Hz
Tone	A, B, E, D, voice and music (optional)
Power	<10W
Color	Red
Sound level	106dB
Ambient temperature	-30°C ~ +70°C
Humidity	10% ~ 95% (no condensing)
IP protection	IP65
Material	Enclosure: cold rolled steel; Housing: PC
Weight	2.0kg

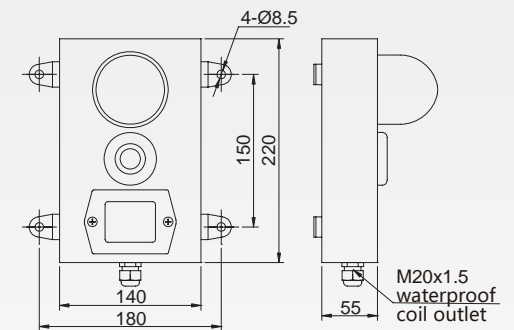

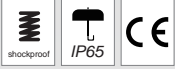

BC-8 Beacon Siren

Application

BC-8 beacon siren special design for all kinds of hoisting machinery (tyre crane, crawler crane, overhead traveling cranes, etc.), harbors machinery (gantry cranes, bridge crane, etc), Plant (electrotechnical box), metallurgies, chemical industry, coalmines and marine etc.

Main Functions & Features

- Enclosure employs die casting aluminum, providing good appearance, lightweight, corrosion resistance.
- The products are sealed with structural glue, to ensure the good waterproof and dustproof of the product.
- Super bright LEDs as lamp bulb, and the life is more than 100,000hrs.
- Lamp housing employs PC, providing good intensity, thermal stability and good finishing surface.
- Special integrated core, providing strong electromagnetic anti-interference capability.
- Various tones and adjustable volume for selection.

Specification

Description	Parameter
Supply voltage	AC24V / AC36V / AC110V / AC220V / AC380V / DC24V (optional)
Frequency	50Hz ~ 60Hz
Power consumption	6W
Tone	A / B / E / D / Y / L / F / Speech (optional)
Sound level	106dB
Color	Red, Amber, Green (optional)
Warning type	Visible and Audible
Ambient temperature	-30°C ~ +70°C
Humidity	10% ~ 95% (no coagulation)
IP protection	IP65
Material	Base: Aluminum alloy ; Housing: PC
Weight	2.7Kg

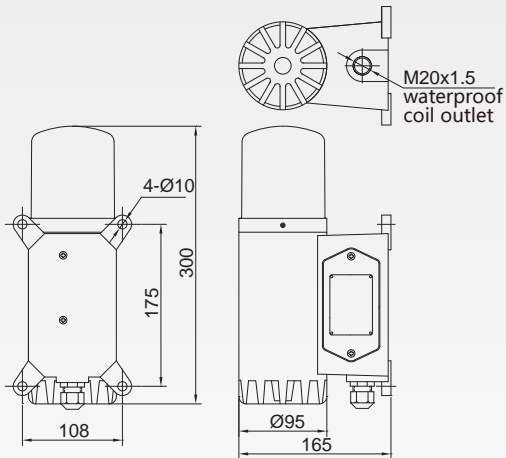

BC-809 Outdoor Siren and Strobe Light

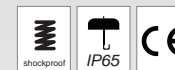

Application

Giving eye – catching audio visual alarms for mechanical engineering (overhead cranes, crawler crane and RTG crane etc), port machinery (gantry cranes and bridge cranes etc).

Main Functions & Features

- Compact size and light weight.
- High brightness, alarm sound and selectable tones.
- Continuous operation, reliability and stability.
- Several tones, and wide applications.
- PC housing – with good anti – impact strength, thermal stability, high transmittance.
- Both xenon light tube and Led light tube are available.
- Several mounting styles for selections, such as screws fixing, magnetic fixing or flange type.

Specification

Description	Parameter
Operating voltage	AC24V ~ AC240V / AC380V
	DC24V~ DC48V (optional)
Frequency	50Hz ~ 60Hz
Tone	A, B, D, E
Power consumption	10W
Color	Red, yellow or green (optional)
Sound level	108dB ~ 110dB
Alarm	Audio – visual alarm
Ambient temperature	-30°C ~ +70°C
Humidity	10% ~ 95% (no condensing)
IP protection	IP65
Material	Housing: Nylon+GF30%; Housing: PC
Weight	0.5kg

Model	Installation
BC-809	3 M6 screws
BC-809C	Magnetic mounting
BC-809F	Flange mounting
PJ061	Special housing

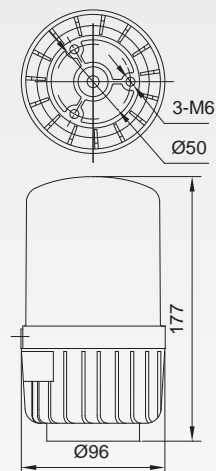

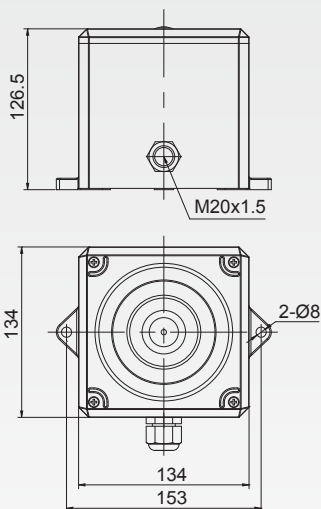
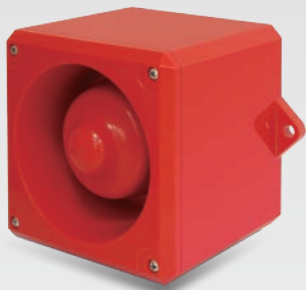
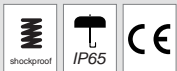

AE001 Tone-selectable Siren

Application

AE001 Tone – selectable siren is designed for harbor machinery, heavy crane applications. It has good appearance, up to 10 tones to select, high IP protection, ease of operation, ease of installation. It also provides good water – proof, anti – shock performance. From result of field testing, multi – tone siren plays a important role on on – site organization, equipment warning and worker safety.

Main Functions & Features

- Various tones available for selection.
- Ease of using, works longly.
- Specific integrated chip design, Good anti – RF.
- Good structural design, ease of operation.
- ABS housing, anti – UV, anti-aging ingredients, salt corrosion resistance, Unique design ensure waterproof, moisture resistance, and shockproof functions.

Specification

Description	Parameter
Ambient temperature	-30°C ~ +70°C
Operating voltage	AC110V ~ AC240V / DC24V / DC48V
Frequency	50Hz ~ 60Hz
Tone	Ten kinds of tones (Adjustable)
Power consumption	10W
Horn Parameters	10W / 8Ω
Sound level	106 ~ 108dB (± 5dB)
Material	Housing: ABS; Light: PC
Weight	1kg
Installation	Using 2Nos. M6 screws
Other Tone	10 tones
Color	Red

Model	Power Consumption	Weight	IP protection	Remark
AE001	8W	0.8kg	IP66	
AL001	10W	1kg	IP65	Voice and Light



BC-30 High power Electronic siren



Application

Specially design for all kinds of hoisting machinery (tyre crane, crawler crane, overhead traveling cranes, etc.), harbors machinery (gantry cranes, bridge crane, etc).

Main Functions & Features

- Aluminum alloy shell, silver sprays technology trumpet, waterproof and corrosion resistance.
- Clear and distinct sound quality and powerful performance.
- Output power: 30W.
- Easy control, alarm can be realized as long as power connected.
- Flexible installation, various environment application.
- Reliable, and stability.
- Trumpet structure, long distance of sound transmission.

Specification

Description	Parameter
Operating voltage	AC220V / DC24V (optional)
Frequency	50Hz ~ 60Hz
Tone	A / B / E / D / Y / L / speech (optional)
Power consumption	30W
Horn impedance	8Ω
Sound level	108dB
Operating temperature	-30°C ~ +70°C
Humidity	10% ~ 95% (no condensing)
IP protection	IP65
Material	Aluminum alloy
Weight	5.0kg

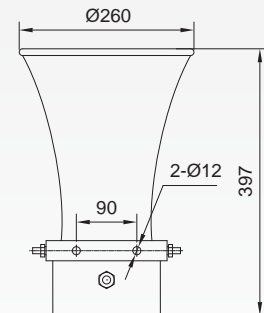
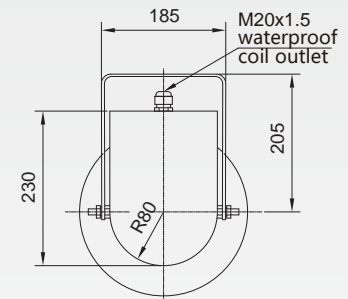

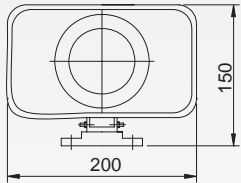
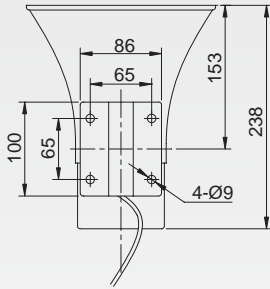
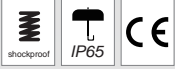

BC-3A Siren

Application

Apply to construction machinery (travelling cranes, crawler crane, gantry cranes etc.), harbor machinery (overhead cranes, bridge cranes,) etc hoist device.

Main Functions & Features

- Multiple tones are available.
- Loud and clear alarm sound.
- Easy of operation, and have a long lifetime.
- Stability.

Specification

Description	Parameter
Supply voltage	AC220V/DC24V (optional)
Power frequency	50Hz~60Hz
Tone	A / B / E / D / Speech (optional)
Loudspeaker Power	10W
Loudspeaker resistance	8Ω / 16Ω
Sound level	106dB
Operating temperature	-30°C ~ +70°C
Humidity	10% ~ 95% (no condensing)
IP protection	IP65
Material	ABS
Weight	1.6kg

BC-8A / 8F Outdoor Siren

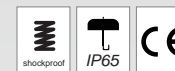

Application

Apply to construction machinery (travelling cranes, crawler crane, gantry cranes etc.), harbor machinery (overhead cranes, bridge cranes,) etc hoist device.

Main Functions & Features

- It employs die – casting aluminum enclosure, providing fashionable and attractive construction, with light weight and corrosion resistant.
- Good sealed performance, with strong waterproof and dustproof.
- Specific integrated chip design, superior performance of EMI.
- Multi – tone is available, volume is adjustable, wide application.

Specification

Description	Parameter
Supply voltage	AC24V / AC36V / AC110V / AC220V / AC380V / DC24V (optional)
Power frequency	50Hz ~ 60Hz
Tone	A / B / E / D / L / speech (optional)
Horn power	10W
Color	Red, yellow, green (optional)
Sound level	108dB
Alarm method	Sound
Operating temperature	-30°C ~ +70°C
Relative humidity	10% ~ 95% (no condensing)
IP Protection	IP65
Material	enclosure: aluminum
Weight	2.7Kg

Model	Tone	Volume adjustable	Other
BC-8A	L		
BC-8AV	Speech		
BC-8F	A		

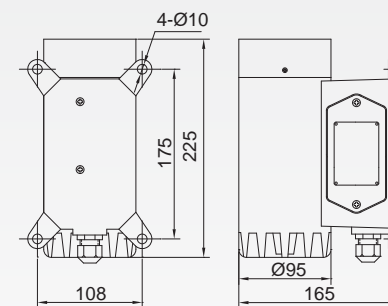
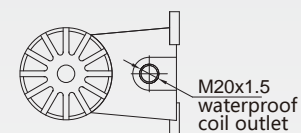



ABC-5A / ABC-12 Revolving warning light

Application

Apply to construction machinery (travelling cranes, crawler crane, gantry cranes etc.), harbor machinery (overhead cranes, bridge cranes,) etc hoist device.

Main Functions & Features

- Several colors for selection.
- Rotation speed can be adjusted as requirement before leaving the factory.
- Sound construction and good appearance.
- Employ transparent PC housing, providing high transmittance UV resistance, anti – aging and impact resistance.
- Vacuum Reflector well improves light diffusion.
- Rotate steadily and noiselessly.
- Gear transmission mode, providing high efficient transmission, reliable work and external long life.



ABC-5A

ABC-12

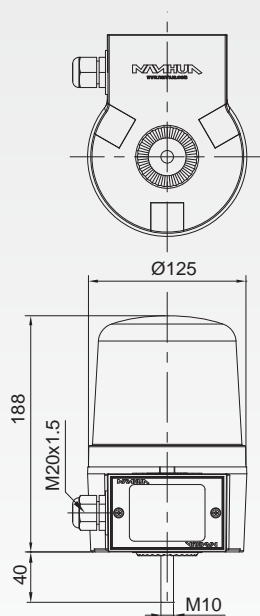

ABC-5A

Specification

Description	Parameter
Operating voltage	AC24V / AC36V / AC110V / AC220V
	AC380V / DC24V (optional)
Frequency	50Hz ~ 60Hz
Speaker power	10w / 23w
Alarm method	Revolving
Color	Red, yellow (optional)
Light type	Bulb
Operating temperature	-30°C ~ +70°C
Humidity	10% ~ 95% (no condensing)
IP protection	IP65
Material	Main body: PA6+30%GF; Housing: PC
Weight	1.42kg (ABC-5A)
	2.6kg (ABC-12)

ABC-9 LED Flashing Light



Application

ABC-9 LED Flash warning light is specially designed for various cranes and tall buildings. The product employs die casting aluminium enclosure and PC housing, which houses super bright LED cluster (high quality xenon flashing tube), providing high efficiency, low power consumption, external long life and stability.

Main Functions & Features

- With the advantages of shockproof, corrosion resistant, waterproof, high transmittance and long life etc.
- Giving eye – catching visual with flashing light, more effective alarm signal.

Specification

Description	Parameter
Operating voltage	AC110V / AC220V / AC380V (optional)
Frequency	50Hz ~ 60Hz
Alarm	Steady burning or flashing mode (35 times / min in default)
Power consumption	<12W
Color	Red, yellow, blue or green (optional)
Light source	LED
Ambient temperature	-30°C ~ +70°C
Humidity	10% ~ 95% (no coagulation)
IP protection	IP65
Material	Base: PA6 + 30% GF; Housing: PC
Weight	1.9kg (Plastic)

Model	Voltage(customized)	Material	Remark
ABC-9	AC220V / DC24V	Nylon	Flashing light source
ABC-9F	AC220V / DC24V	Nylon	Steady burning light source
ABC-9P	AC110V / AC220V	Nylon	Hemia tubes
ABC-9L	AC220V / DC24V	aluminium alloy	Flashing or Steady burning
ABC-9H	AC420V / AC460V	aluminium alloy	High voltage

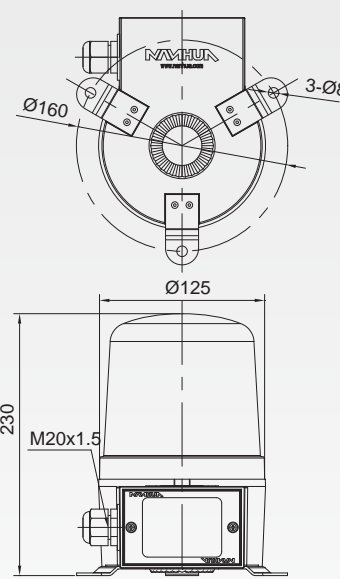



LS130 / LS131 Flashing Warning Light

Application

Used in the cabs of engineering machinery (travelling cranes, crawler cranes, truck cranes etc.), harbor crane (gantry crane, bridge crane etc.).

Main Functions & Features

- LED flashing light ensure extreme long lifetime and low power consumption.
- Aluminum basement supply good ability of heat dissipation.
- Waterproof and Shockproof, corrosion and UV resistance.
- Ease of mount.
- Two different mounting way for selection, magnet or flange.

Specification

Description	Parameter
Operating voltage	DC12V / DC24V (optional)
Power consumption	10W
Alarm	Flashing (frequency: 7Hz)
Light source	LED
Color	red, amber (optional)
Ambient temperature	-20°C ~ +60°C
Humidity	10% ~ 95% (non – condensing)
IP protection	IP65
Material	Basement: aluminum; Housing: PC
Weight	0.5kg



LS130



LS131

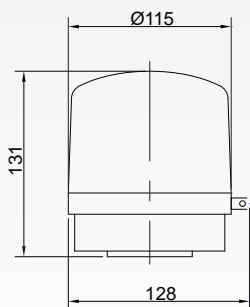

LS130

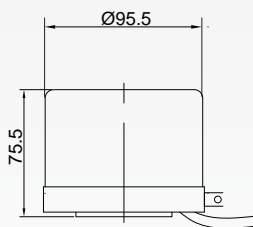

LS131

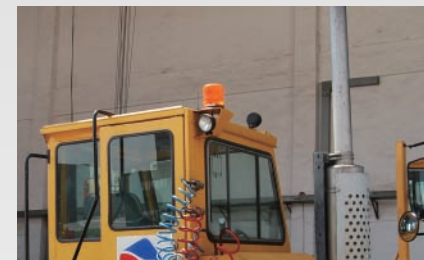

DT Digital Intercom & Paging System

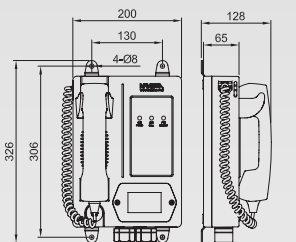

DT001 Indoor Station

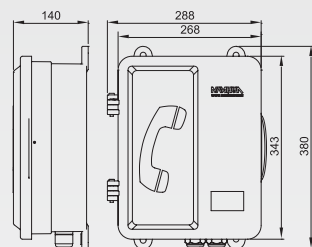

DT002 Outdoor Station

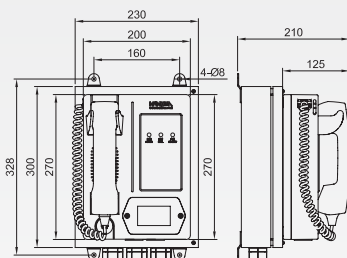

DT003 Driver's Scabinet Station

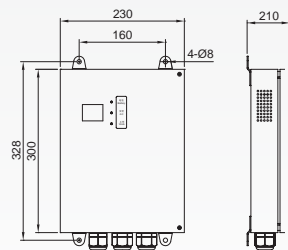

DT004 Power supply

Application

Digital intercom is network communication system designed for harsh environments and work site with strong EMI, like port, power plant, mining, chemical plant, hoisting machinery, railway tunnel, Steel and Iron Works, etc.

Main Functions & Features

- Connect with one 2 – core cable, nice and easy netting.
- Ideal product for harsh environments and various applications.
- Use advanced OFDM interference technology, have good EMI resistance performance, EMC compatibility.
- Digital signal processing technology, non – loss data condensing makes no voice transmission loss and provide crispy voice quality, support 3 party communication, multi – party communication.
- Broadcasting priority.
- -15dB environment noise threshold value, lower interference.
- Auto switching off if no audio input in 2 minutes and go to sleeping mode.
- Support point – point, cascade and spreading netting.
- Auto power adjustment, auto temperature compensate, auto recover, over load protection, auto mute.
- Adjustable broadcasting volume in different working environment.
- System working voltage 24VDC, input power supply uses AC110V ± 10% or AC220V ± 10%; has backup power supply (DC24V battery) connection terminal, the main power supply can be automatically switch to the backup battery when the main power is not available.
- Any phone station can broadcasting call whole working field, which makes finding someone and making an announcement nice and easy.
- Easy of operation, LED working status indication.
- Indoor station adopts phone and speaker all in one design, easy to installation and operation.
- Outdoor station comes with lock, can work under harsh environment.

Specification

Description	Parameter
Operating voltage	DC24V
Power supply	Central power supply from power supply box
Main power supply	AC110V ± 10% / AC220V ± 10%
Backup power supply	DC24V (provide by user)
	Set the system power as circle centre, the
Communication distance	MAX semi diameter is 400m
System netting numbers	Standard for 8 stations MAX: 20 stations
Running mode	Long – term
Ambient temperature	-30°C ~ +70°C
Humidity	10% ~ 95% (No coagulation)
IP protection	IP65
Material	DT001: ABS;DT002: PC + ABS; DT003 / 004: Cold Rolled Sheet + Plastic Painted



DT001 Indoor station



DT001 Outdoor station



DT003 Driver's cabinet station



DT004 Power supply

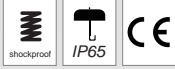

FA101A

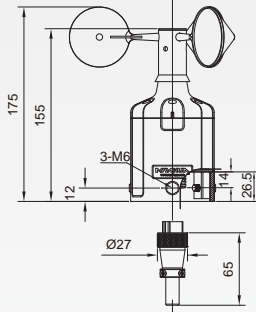
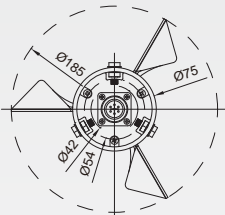

FA101 Anemometer

Application

Special design for plant, electric power, harbor, factories and mines, wind generator etc large mechanical equipments.

Main Functions & Features

- Use digital communication mode between anemometer and digital readout, and also with CRC data communication check, date redundancy check and digital filtering etc to improve the system stability and anti – jamming capability.
- 12bit definition current loop alarm output, two channels relay control output, and buzzer gives an emergency sound.
- Mini displayer, with four – figure display. Can display the wind speed and wind scale.
- Airspeed sensor, providing good corrosion resistant, strong anti – wind ability, up to 16 scale.
- Multi – channels signals alarm output, for wide application.
- Wide applicable working voltage: AC85 ~ AC265V.
- Independent palm specification setting, for reading figures on the instrument and adjusting it, ensuring the correct alarm data.
- Adjustment free.

Description	Parameter
Supply voltage	AC85V ~ AC265V (FA101C)
Measuring range	0 ~ 60 (m / s) i.e.0 ~ 17 wind scales
Measurement tolerance	(0.1 + 0.05x actual wind speed) m/s
Toggle speed	Toggle speed 0.5m/s
Anti – wind strength	Max.wind resistance: ≥ 60m/s
Sensor output	current loop 4 ~ 20mA output; RL<400Ω
Communication	RS485
Multi – channels alarm output	2 channel relay control output (2NO / 2NC), Internal alarm, sound output and digital communication output
Digital display	Display: four digits Display content: wind speed and wind scale (switchable) Refreshing frequency: 1s / time
Ambient temperature	30°C ~ +70°C
IP protection	IP65 (FA101A)
Material	Anemometer: PC+ABS Control box: PC
Humidity	10% ~ 95% (no coagulation)
Weight	FA101A: 0.3Kg; FA101C: 0.5Kg



FA101C

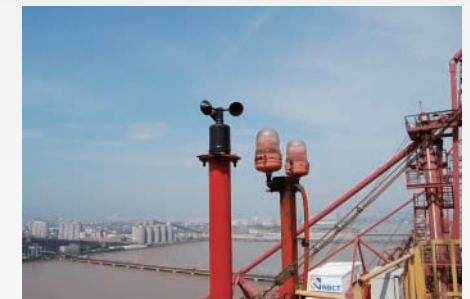
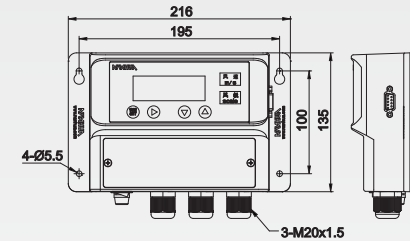
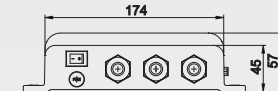

FA131A+FA132A+FA130C Anemometer and wind vane

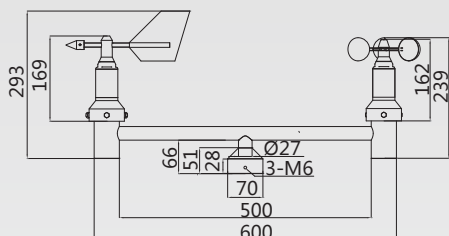
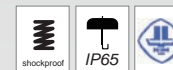

FA131A+FA132A+PJ300

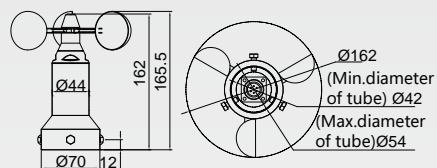

FA131A

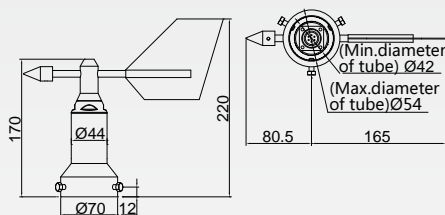

FA132A

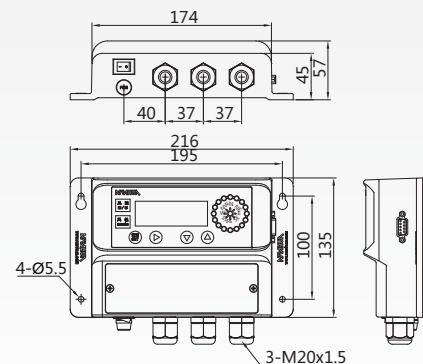

FA130C

Application

Special design for plant, electric power, harbor, factories and mines, wind generator etc large mechanical equipments.

Main Functions & Features

- Anemometer sensor use magnetic sensor measuring principle.
- Sensor data collected with high precision and reliability.
- Wind speed measurement with wide range, low wind speed start.
- Wind speed sensor / vane use metal enclosure, corrosion resistant and strong anti-wind capability.
- Wind cup stainless steel can be used in harsh conditions
- Compact sensor design, set wind speed measurement, heating device in one, easy installation and maintenance.
- Sensor fault-tolerant design, sensor will not be damaged even wrong wiring.
- Multilevel lighting protection and surge protection.
- Work over a wide voltage range.

Specification

Description	Parameter
Operating voltage	VCC = DC12V - DC30V
Measuring range	0.5 - 50m / s
Wind speed start Anti-wind intensity	≤ 0.5 m / s 70 m / s
Precision	FA131A: ± 0.5 m / s (< 5m / s) Measure data ± 3% (≥ 5m / s)
Heating type	Automatic
Heating voltage	DC24V ± 6V
Heating power	≤ 50 W
Surge protection	4KV / 2KA
ESD protection	15KV
Ambient temperature	-40 C ~ +70 C
Humidity	0%~99%
Material	FA131A: Wind cup: Stainless Steel Bearing: Stainless Steel 440C FA132A: Vane: Carbon fiber + stainless steel 304 Bearing: Stainless Steel 440C
IP protection	IP65
Weight	FA131A: 0.6KG FA132A: 0.6KG
Enclosure	Aluminum alloy / Fluorocarbon coating
Bearing supplier	NMB / EZO
Signal output	FA131A: UART FA132A: 4 ~ 20mA current (linear correspond 0~360°), load resistance ≤500Ω



FA131A+FA132A+PJ300



FA131A



FA132A



FA130C

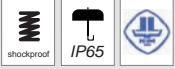

FA13 series wind speed sensor

Application

Special design for plant, electric power, harbor, factories and mines, wind generator etc large mechanical equipments.

Main Functions & Features

- Anemometer sensor use magnetic sensor measuring principle.
- Sensor data collected with high precision and reliability.
- Wind speed measurement with wide range, low wind speed start.
- Wind speed sensor / vane use metal enclosure, corrosion resistant and strong anti - wind capability.
- Wind cup stainless steel can be used work in harsh conditions
- Compact sensor design, set wind speed measurement, heating device in one, easy installation and maintenance.
- Sensor fault - tolerant design, sensor will not be damaged even wrong wiring.
- Multilevel lighting protection and surge protection.
- Work over a wide voltage range.



FA131A / FA133A / FA135A



FA131D / FA133D / FA135D

Specification

Description	Parameter
Operating voltage	VCC=DC12V - DC30V
Measuring range	0.5 ~ 50m/s
Wind speed start	≤ 0.5m / s
Anti - wind intensity	70 m / s
Precision	± 0.5 m / s (<5m/s) ; Measure data ± 3% (≥ 5 m / s)
Heating type	Automatic
Heating voltage	DC24V ± 6V
Heating power	≤ 50W
Surge protection	4KV / 2KA
ESD protection	15KV
Ambient temperature	-40 °C ~ +70 °C
Humidity	0% ~ 99%
Wind cup	Stainless Steel
IP protection	IP65
Bearing	Stainless Steel 440C
Weight	0.6KG
Enclosure	Aluminum alloy / Fluorocarbon coating
Bearing supplier	NMB / EZO
Signal output	UART

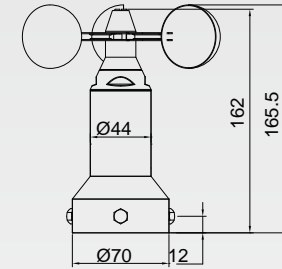
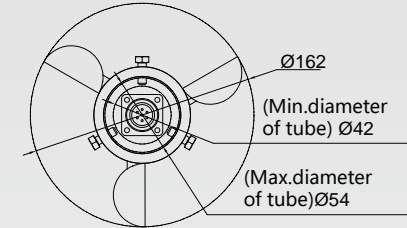

FA131A / FA133A / FA135A

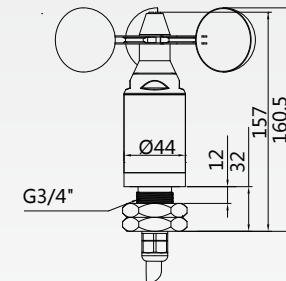

FA131D / FA133D / FA135D

Model	Mounting method	Wiring	Signal
FA131A	Φ42~Φ54 pipe	Aviation plug connector	Asynchronous serial port output, baud rate 300, eight bit data, no parity, one stop bit, signal range 0 - VCC. Match Nanhua FA101C or FA130C display panel.
FA131B	Self-balanced	Lead wire	
FA131D	G3/4" whorl		
FA133A	Φ42~Φ54 pipe	Aviation plug connector	4 ~ 20mA three - wire current loop ; load resistance ≤ 500Ω
FA133B	Self-balanced	Lead wire	
FA133D	G3/4" whorl		
FA135A	Φ42~Φ54 pipe	Aviation plug connector	NPN pulse signal; 0.5m / s=2Hz; 50m / s=573 Hz; V[m / s]=0.08669 × f [Hz] + 0.32;
FA135B	Self-balanced	Lead wire	
FA135D	G3/4" whorl		

FA132X Wind direction sensor

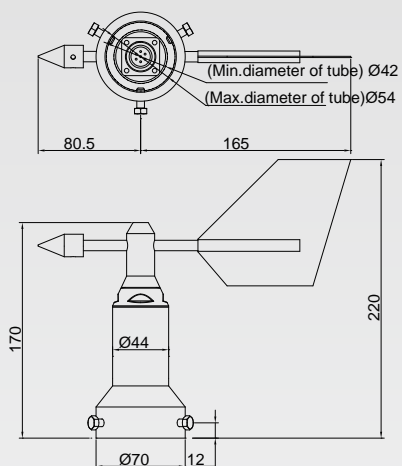
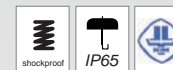

FA132A

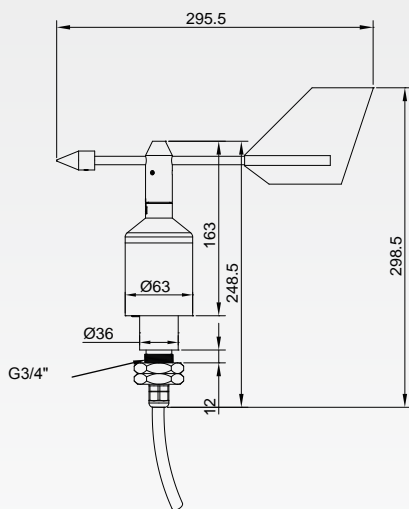

FA132D

Application

Special design for plant, electric power, harbor, factories and mines, wind generator etc large mechanical equipments.

Main Functions & Features

- Based on magnetic sensor measuring principle.
- Sensor data collected with high precision and reliability.
- Wind speed measurement with wide range, low wind speed threshold.
- Full metal enclosure with corrosion resistant and strong anti – wind capability.
- Compact sensor design, integrates wind direction measurement and heating device. Easy installation and maintenance.
- Fault – tolerant design, sensor will not be damaged even wrong wiring.
- Wide supply power voltage range.

Specification

Description	Parameter
Operation voltage	VCC=DC12V – DC30V
Mesuring range	0° ~ 360°
Threshold	≤ 0.5 m / s
Anti – wind levrl	70 m / s
Accuracy	± 3°
Heating type	Automatic
Heating voltage	DC24V
Heating power	≤ 50W
Surge protection	6KV / 5KA
ESD protection	15KV
Signal output	4 ~ 20mA three – wire current loop (linear mapping 0 ~ 360° direction); load resistance ≤ 500Ω
Ambient temperature	-40° C ~ +60° C
IP protection	IP65
Humidity	0% ~ 99%
Weight	0.5 KG
Vane material	carbon fibre + stainless steel
Body material	carbon fibre + aluminum alloy
Bearing	Stainless Steel and Special lubricants

Model	Mounting method	Wiring	Signal
FA132A	Φ42 ~ Φ52 pipe	Aviation plug connector	4 ~ 20mA three-wire current loop (linear mapping 0-360° direction); load resistance≤500Ω;
FA132D	G3 / 4" whorl	Lead wire	



FA132A



FA132D

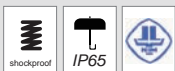

FA131B / FA133B / FA135B

FA13XB Self – balance Wind Speed Sensor

Application

Special design for Crawler crane, Truck crane, Bridge inspection vehicle etc. large lift, cantilever machinery.

Main Functions & Features

- Anemometer sensor use magnetic sensor measuring principle.
- Sensor data collected with high precision and reliability.
- Special design for heavy equipment, modern design, self – adjusting vertical angle.
- Wind speed measurement with wide range, low wind speed start.
- Wind speed sensor use metal enclosure, corrosion resistant and strong anti – wind capability.
- Wind cup stainless steel can be used in harsh conditions.
- Compact sensor design, set wind speed measurement, heating device in one, easy installation and maintenance.
- Sensor fault – tolerant design, sensor will not be damaged even wrong wiring.
- Surge protection design.
- Wide supply voltage range.

Specification

Description	Parameter
Operating voltage	VCC=DC12V – DC30V
Range	0.5 ~ 50m / s
Start speed	≤ 0.5m / s
Anti – wind level	>70 m/s
Accuracy	± 0.5 m / s (< 5m / s) Measuring vale ±3% (≥5 m / s)
Heating type	Automatic
Heating voltage	DC24V ± 6V
Heating power	≤ 50W
Surge protection	4KV / 2KA
ESD protection	15KV
Ambient temperature	-40°C ~ +70°C
Humidity	0% ~ 99%
Body material	Aluminum alloy / Fluorocarbon coating
IP protection	IP65
Wind cup material	Stainless Steel 304
Bearing material	Stainless Steel 440C
Weight	2.5KG

Model	Signal
FA131B	UART :Universal Asynchronous Receiver / Transmitter, baud rate 300, eight bit data, no parity, one stop bit, signal range 0 ~ VCC. Match Nanhua FA101C or FA130C display panel.
FA133B	4 ~ 0mA three-wire current loop; load resistance 500Ω.
FA135B	NPN pulse signal; 0.5m / s=2Hz; 50m/s=573Hz V [m / s] = 0.08669 × f [Hz]+0.32.

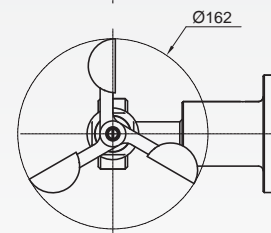
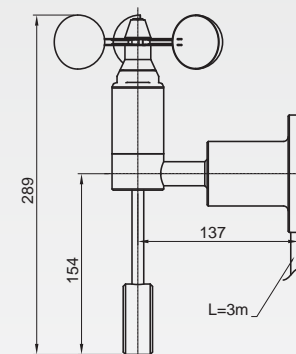
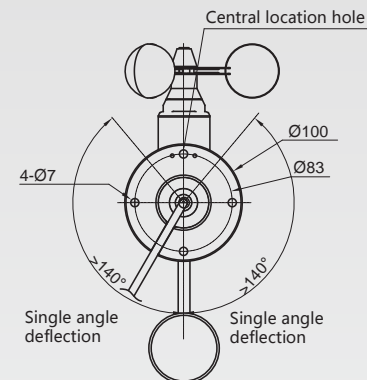

FA211A+FA130C Wind speed and direction vane

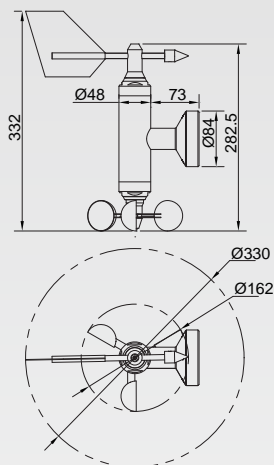
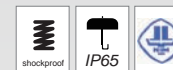

FA211A

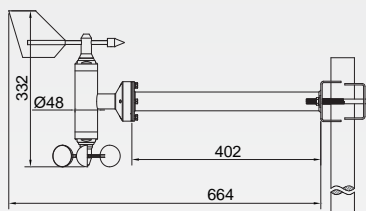

FA211A+PJ3001

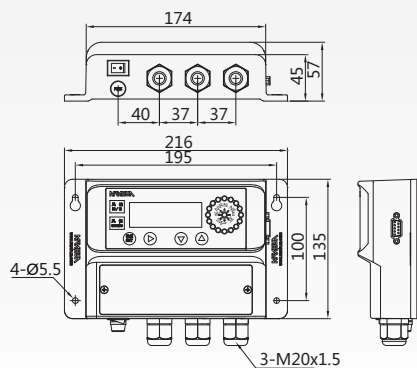

FA130C

Application

Special design for plant, electric power, harbor, factories and mines, wind generator etc large mechanical equipments.

Main Functions & Features

- Anemometer sensor use magnetic sensor measuring principle.
- Sensor data collected with high precision and reliability.
- Wind speed measurement with wide range, low wind speed start.
- Wind speed sensor/vane use metal enclosure, corrosion resistant and strong anti - wind capability
- Wind cup stainless steel can be used in harsh conditions.
- Compact sensor design, set wind speed measurement, heating device in one, easy installation and maintenance.
- Sensor fault - tolerant design, sensor will not be damaged even wrong wiring.
- Multilevel lighting protection and surge protection.
- Work over a wide voltage range.

Specification

Description	Parameter
Voltage	VCC = DC12 - DC30V
Wind speed range	0.5 - 50m / s
Wind speed Signal	UART signal
Wind direction range	0 ~ 360°
Wind direction signal	4 ~ 20mA current (linear correspond 0 ~ 360°), load resistance ≤ 500Ω
Heating voltage	DC24V ± 6V
Heating type	Automatic
Surge protection	4KV /2KA
Start speed	≤ 0.5m / s
Accuracy	± 0.5 m / s (<5m/s) Measuring vale ± 3% (≥5 m/s)
Accuracy	± 3°
Heating power	≤ 100W
Anti-wind level	> 70 m / s
ESD protection	15KV
Ambient temperature	-40°C ~ +70°C
IP protection	IP65
Humidity	0% ~ 99%
Body material	Aluminum alloy / Fluorocarbon coating
Wind cup material	Stainless Steel 304
Bearing material	Stainless Steel 440C
Vane material	Carbon fiber + stainless steel 304
Bearing supplier	NMB / EZO
Weight	2.8KG



FA211A



FA211A+PJ3001



FA130C



FA21xA Wind speed and direction vane

Application

Special design for heavy machinery of planets, electric power, wind industry, harbor, factory and mine, etc.

Main Functions & Features

- Wind sensor use magnetic sensor measuring principle.
- Sensor data collected with high precision and reliability.
- Wind speed measurement with wide range, low wind speed start.
- Wind speed sensor use metal enclosure, corrosion resistant and strong anti-wind capability
- Wind cup stainless steel can be used in harsh conditions.
- Compact sensor design, set wind speed measurement, heating device in one, easy installation and maintenance.
- Sensor fault-tolerant design, sensor will not be damaged even wrong wiring.
- Surge protection design.
- Wide supply power voltage range.
- Various signal output, suit for different application.



FA211A / 213A / 215A



FA211A / 213A / 215A +PJ3001

Specification

Description	Parameter
Voltage	VCC = DC12 - DC30V
Start speed	≤ 0.5m / s
Wind speed range Accuracy	0.5 - 50m / s ± 0.5 m / s (<5m / s) Measuring vane ± 3% (≥5 m/s)
Wind direction range	0 ~ 360°
Accuracy	± 3°
Wind direction signal	4 ~ 20mA current (linear correspond 0 ~ 360°), load resistance ≤ 500Ω
Heating voltage	DC24V ± 6V
Heating power	≤ 100W
Heating type	Automatic
Anti-wind level	>70 m / s
Surge protection	4KV / 2KA
ESD protection	15KV
Temperature	-40 C ~ +70 C
Humidity	0% ~ 99%
Body material	Aluminum alloy / Fluorocarbon coating
IP rate	IP65
Wind cup material	Stainless Steel 304
Vane material	Carbon fiber + stainless steel 304
Bearing material	Stainless Steel 440C
Bearing supplier	NMB / EZO
Weight	2.8KG

Model	Wind speed signal
FA211A	UART signal (Match with NANHUA FA130C display)
FA213A	4 ~ 20mA current (linear correspond 0 ~ 50m / s), load resistance ≤ 500Ω
FA215A	NPN pulse signal; 0.5m / s = 2Hz; 50m / s = 573 Hz V [m / s] = 0.08669 × f [Hz] + 0.32

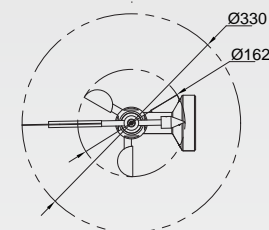
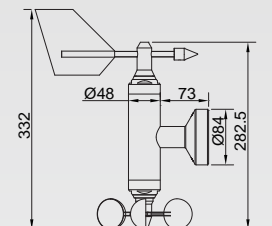

FA211A / 213A / 215A

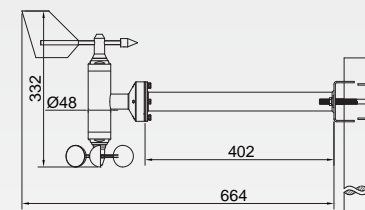

FA211A / 213A / 215A +PJ3001

AE401 Anti – collision Device

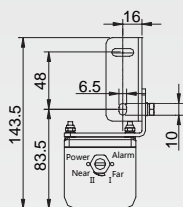
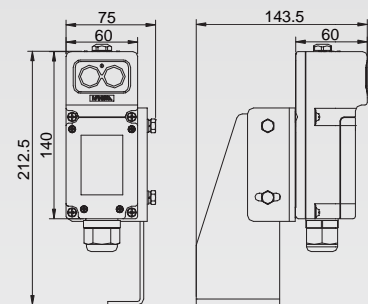

AE401A

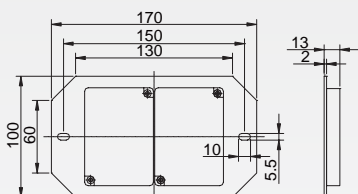

AE401B

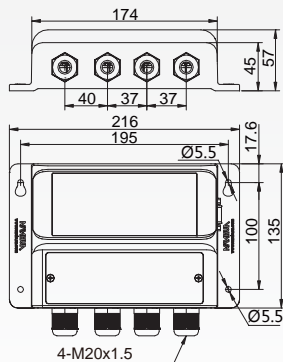

AE401C

Application

Overhead crane, off – shore crane, RMG, RTG, etc. track – operating Crane equipments.

Main Functions & Features

- Infrared sensor, the maximal detect distance is 20M.
- Two sensors on left and right side, can monitor the left and right direction.
- With alarm function and alarm sound adjustable.
- Laser focus, high precision.
- High – integrated design; Easy installation; High quality.
- Self – check function.

Specification

Description	Parameter
Operating voltage	AC90 ~ 240V / DC24V (optional)
Frequency	50Hz ~ 60Hz
Alarm Volume	80dB
Reaction Time	0.5s
Operation Distance	Level I: 5 ~ 20m adjustable Level II: 3 ~ 12m adjustable
Power consumption	AE401A: ≤10W AE401C: ≤20W
Output contact Load	AE401A: 0.5A 125VAC / 1A 30VDC AE401C: 12A 125VAC / 7A 250VAC / 7A 30VDC
Ambient temperature	-30°C ~ +70°C
IP protection	AE401A: IP65 AE401C: Indoor type
Humidity	0% ~ 95% (no condensation)
Installation	Screw



AE401A Emitter/Sensor









AE401B Reflector

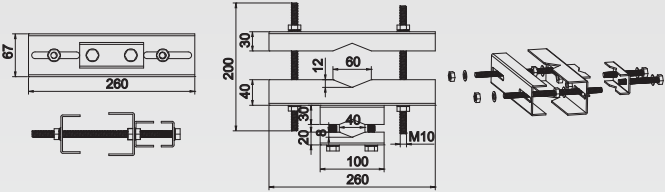

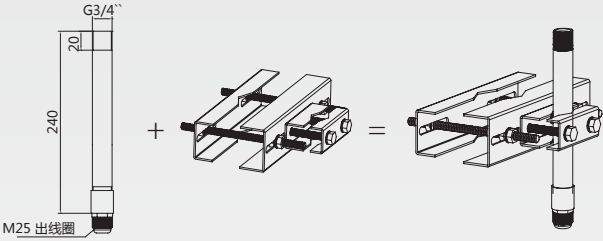

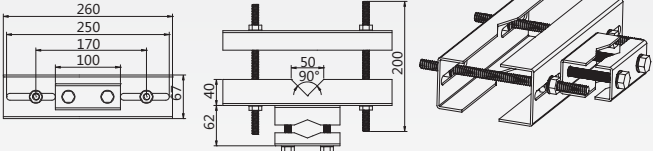
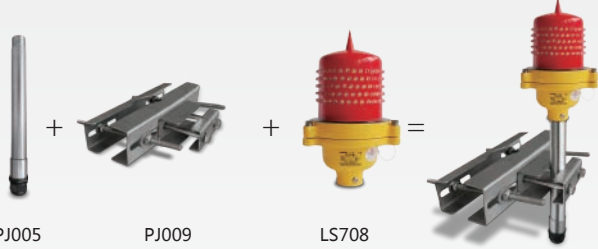
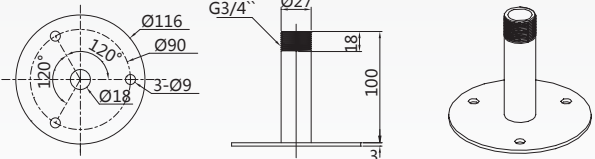



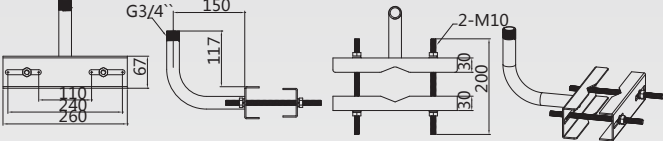

AE401C Digital display

▼ Installation Accessories

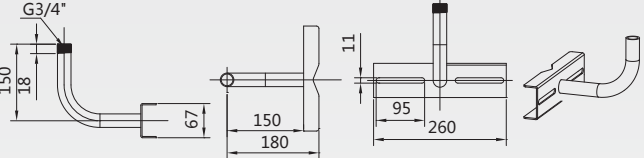
Installation Dimension (mm)	Material Object Installation Diagram
<p>A</p> 	 <p>PJ002 ABC-7L</p>
<p>B</p>  <p>PJ005 PJ009</p>	 <p>PJ005 PJ009 LS710</p>
<p>C</p> 	 <p>PJ005 PJ009 LS708</p>
<p>D</p> 	 <p>PJ024 LS710</p>

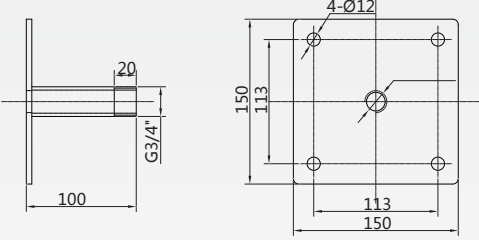
- A** PJ002 Mounting Bracket
- B** PJ005 Mounting Pole
- C** PJ009 Mounting Bracket
- D** PJ024 Flange Mounting Pole

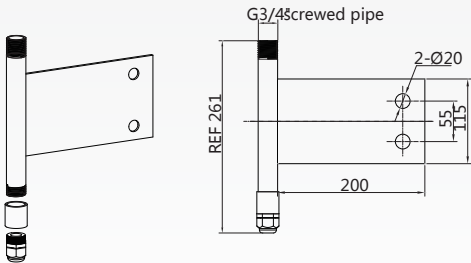
▼ Installation Accessories

Installation Dimension (mm)	Material Object Installation Diagram
<p>E</p> 	 <p>PJ028 LS708</p>
<p>F</p> 	 <p>PJ030 LS710</p>
<p>G</p> 	 <p>PJ067 LS710</p>
<p>H</p> 	 <p>PJ069 LT101</p>

- E** PJ028 Mounting Bracket
- F** PJ030 Mounting Bracket
- G** PJ067 Mounting Bracket
- H** PJ069 Mounting Bracket

▼ Installation Accessories

Installation Dimension (mm)	
<p>❶</p>	
Material Object Installation Diagram	
<p>PJ089</p>	<p>+</p> <p>LM100</p> <p>=</p>
Installation Dimension (mm)	Material Object Installation Diagram
<p>❷</p>	<p>PJ090</p> <p>+</p> <p>LM101</p> <p>=</p>

- ❶ PJ089 Mounting Bracket
- ❷ PJ090 Mounting Bracket



Nanhua Electronics Co.,Ltd

Add : Building 9, No.1755 Wenbei Rd, Jiading district, Shanghai

PC : 201802

Tel : 0086 21 39126868

Fax : 0086 21 39126868 EXT.808/818

Website : en.nanhua.com

Email: sales@nanhua.com